

## DESCRIPTION

AMCOM's AM000501XD-P3 is a high IP3 passive double balanced mixer operates with LO drive level range of +4dBm to +10dBm.



## FEATURES

- LO/RF: 2-500MHz
- IF: DC-500MHz
- LO Level: +7dBm
- Conversion Loss: 6dB
- RF Input: Up to +1dBm
- IP3: +16dBm
- SMA Connector

## APPLICATIONS

- Telecom Infrastructure
- Military & Aerospace
- VSAT
- Test & Instrumentation
- Radar
- Communication

## Electrical Specifications @ +25 °C, IF=30MHz, LO=+7dBm, 50 Ω

Unless otherwise noted, all measurements performed as a downconverter.

Parameter	Unit	Minimum	Typical	Maximum
Frequency Range				
LO/RF	MHz	2		500
IF	MHz	DC		500
Conversion Loss	dB		6.0	8.0
LO-RF Isolation				
2-20MHz	dB	50	55	
20-250MHz	dB	30	45	
250-500MHz	dB	25	40	
LO-IF Isolation				
2-20MHz	dB	45	55	
20-250MHz	dB	25	45	
250-500MHz	dB	20	30	
RF Input Power up to	dBm		+1	
Input IP3 (Center Band)	dBm		+16	

Typical Performance @ +25 °C

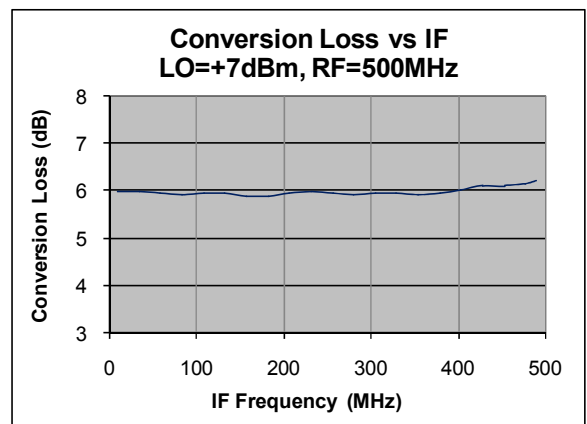
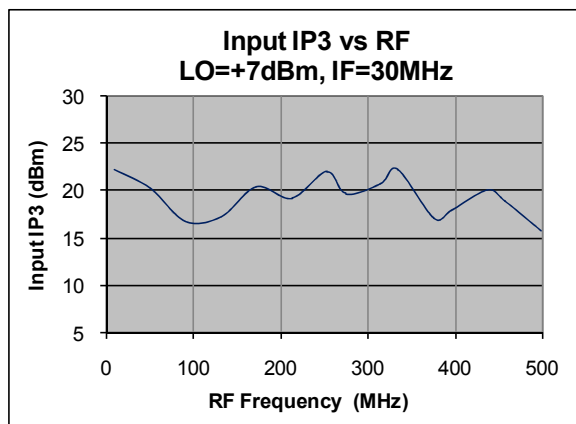
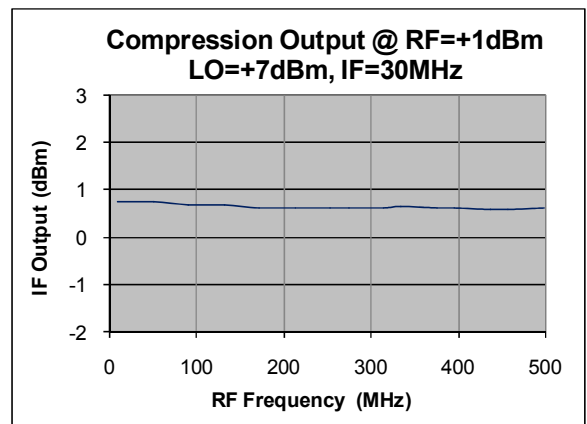
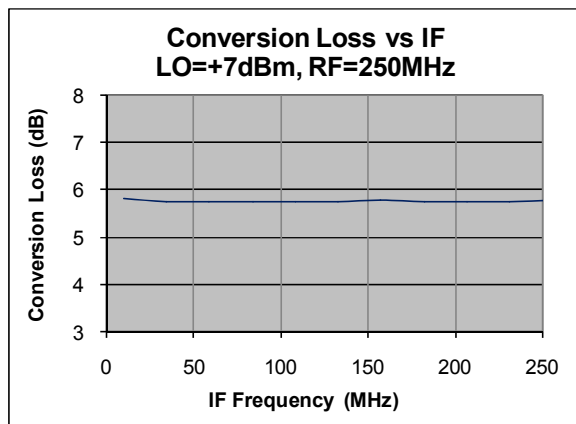
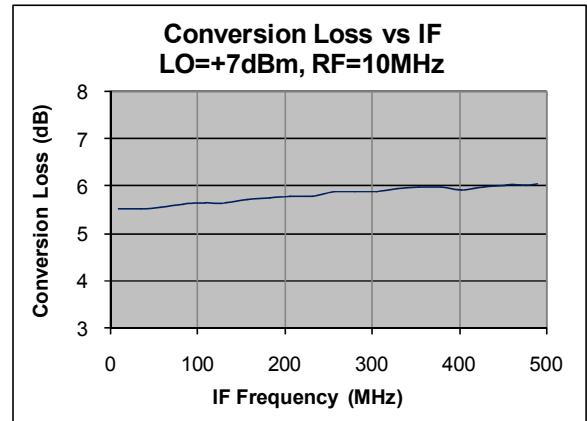
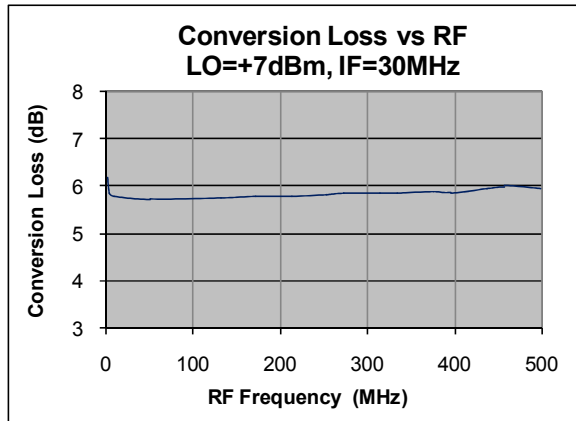

Typical Performance @ +25 °C

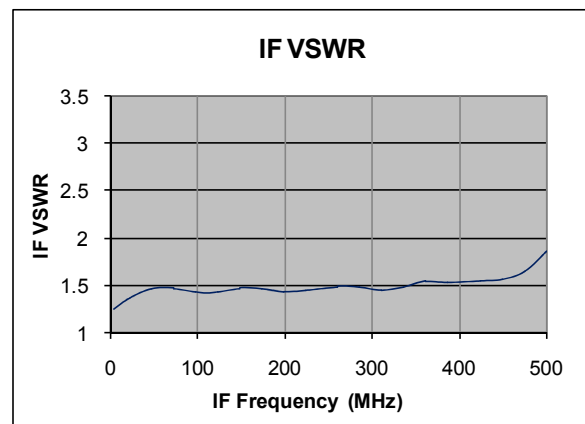
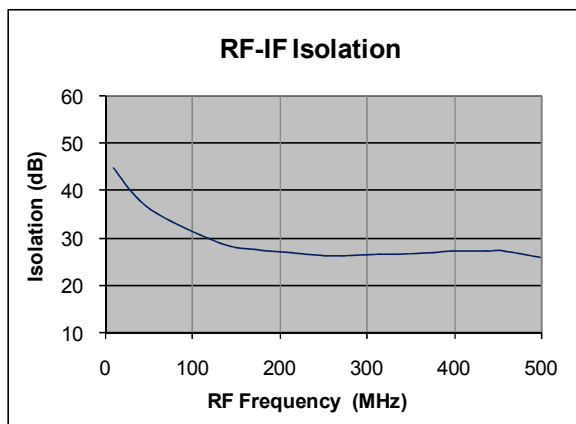
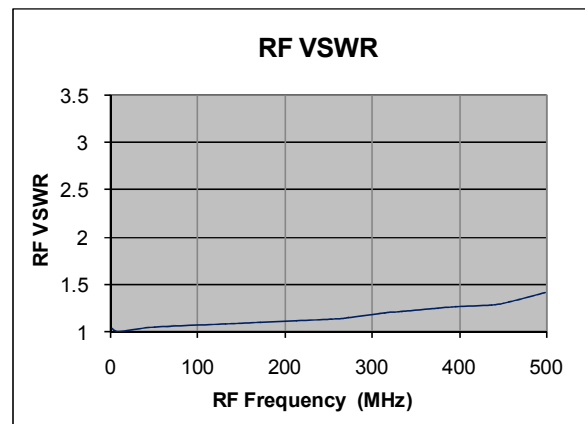
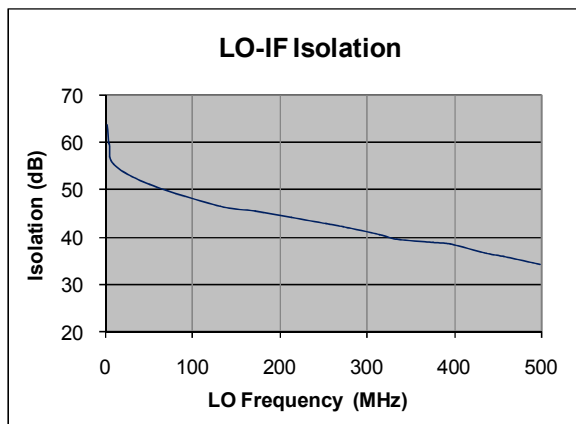
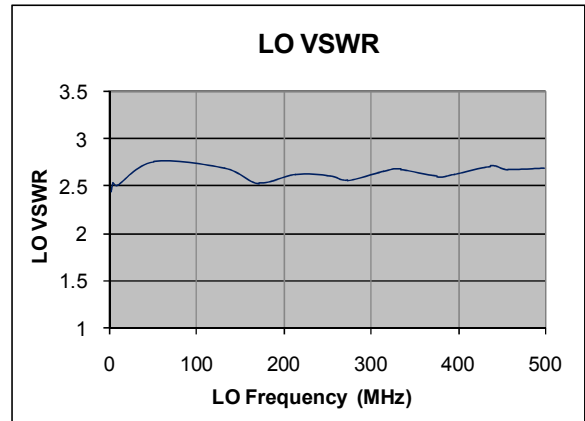
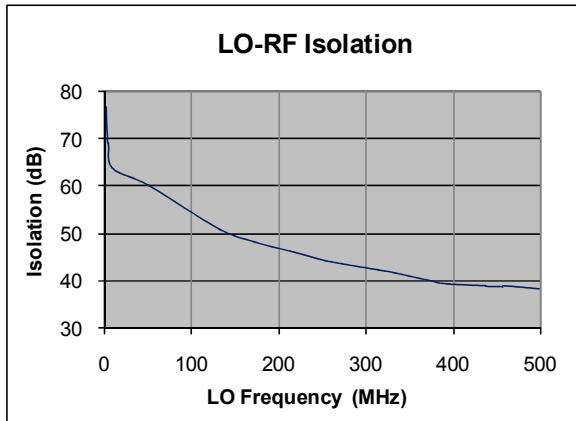

### Absolute Maximum Ratings

Parameter	Absolute Maximum
RF Power	+17dBm
Peak IF Current	40mA
Operating Temperature	-40 °C to +85 °C
Storage Temperature	-55 °C to +100 °C

### Schematic

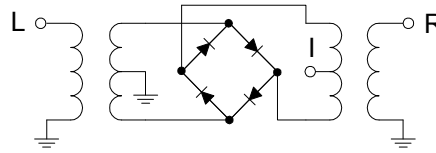

### Outline

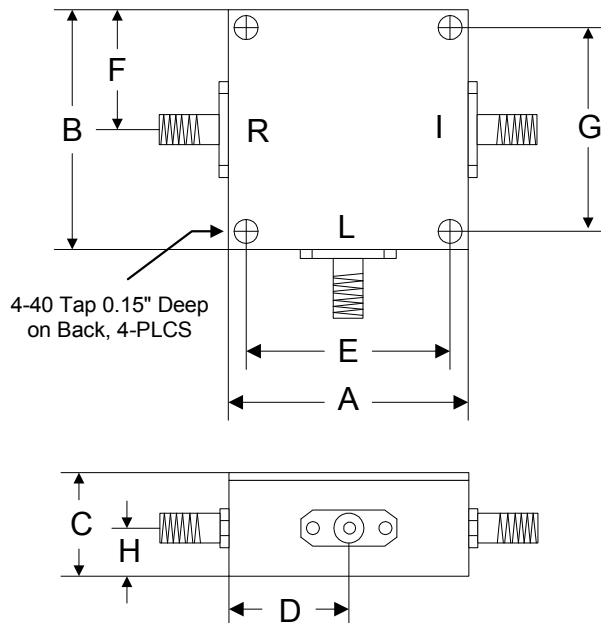

	A	B	C	D	E	F	G	H
Inch	1.250	1.250	0.563	0.625	1.000	0.625	1.000	0.250
mm	31.75	31.75	14.29	15.88	25.40	15.88	25.40	6.35