



MUSH SWEETWATER CHALLENGE AT STEARNS SIDING

***** COVID 19 - SPECIAL CHANGES BELOW *****

SLED DOG RACE #2

FEBRUARY 6 - 7, 2021

RACE SPONSORED BY IRONS ANIMAL HOSPITAL, DR. ELIZABETH KAUFFMAN, DVM

Race will be held at STEARNS SIDING, BALDWIN, MICHIGAN, see map on reverse side.

The club is amateur in nature, emphasizing sportsmanship, fun, and family participation.

MANDATORY Drivers Meeting 9:30 a.m. Saturday. Events begin at 11:00 a.m. Saturday and 10:00 a.m. Sunday. This race will be governed by official **M.U.S.H.** Race Rules; dog bags required in all classes except kiddie, no whips allowed. Passengers at discretion of Race Marshal. Any questions on mileage - check with Race Chairman PRIOR TO RACE to verify mileage.

***** ONLINE PRE-ENTRY AT: events.bytepro.net *****
RACE UPDATES CALL: COLD LINE: 616-607-MUSH (616-607-6874)
WEB PAGE: www.midunionsledhaulers.com

CHRISTY FELTY **LINDA LANGE** **ANNIE HAMMOND** Race Chairpersons
C(231) 907-1573 H(231) 745-3614 C(517) 348-2737
ROBIN HUMMEL CLARK Director of Timing
(269) 274-1038

IN CASE OF CANCELLED RACE, ALL CHECKS WILL BE DESTROYED UNLESS OTHERWISE NOTED.

***** PRE-ENTRIES MUST BE RECEIVED BY WEDNESDAY FEBRUARY 3, 2021 *****

MAIL ENTRIES TO: Robin Hummel Clark, Director of Timing, 132 Winding Wood Way, Battle Creek, MI 49014 **E-MAIL:** snobizclark@comcast.net
***** NO LATE ENTRIES - NO EXCEPTIONS *****

PROPOSED MILEAGE	SPECIAL NOTES	SPECIAL NOTES
3 Dog Race: 3.1 Junior Race: 3.1 (Age 10 - 15)	Drag Brake Mats are highly recommended in addition to the mandatory brake. MUST carry out your trash when you leave. <u>Porta Potty on site. There will be a \$20 Event Fee for the weekend.</u>	NEW EQUIPMENT RULE: Each sled shall be equipped with a starting loop. A starting loop will be a rope loop, not a metal ring, at least six (6) inches in length and extending twelve (12) to twenty-four (24) inches to the rear of the last stanchion. The purpose of this loop is to hold the team at the start line in the starting chute. This loop is not to be configured or used to secure the driver to the sled. If the loop should break or fail to hold the team it will be treated as any other equipment failure.
NEW Senior Dog Race: 2.4 5 Dog Race: 5.62 7 Dog Race: 8.56 Ski-joring 1-Dog: 2.4 Ski-joring 2-Dog: 2.4	Anchor Line definition: It will be the responsibility of the Race giving Organization to supply 2 lines anchored at the same point, each being 35 feet in length and anchored to hold the largest team to be at their event. It is suggested that each of the 35 foot length ropes have a 6 inch to 8 inch loop at one end to hook the starting loop (from the sled) to. The connection of the anchor line and starting loop shall be considered the starting point of the team.	NO WEIGHTPULL No water or electricity on site. No food will be available at the race site.
	Starting Time: Teams shall be anchored at the start line at its scheduled start time.	NO NO NO'S

MOTELS	MOTELS	MOTELS
CLOUD 9 RESORT - (231) 745-3070 3360 S. M-37 Baldwin, Michigan 49304 cloud9baldwin@sbcglobal.net	OUTDOOR INN - (231) 745-3137 7176 SOUTH M-37 Baldwin, Michigan 49304 baldwinoutdoorinn@gmail.com	BATCHE'S BALDWIN CREEK MOTEL (231) 745-4401 7038 SOUTH M-37 Baldwin, Michigan 49304 www.baldwincreeklodge.com
		BBT MOTEL (231) 746-3529 9425 SOUTH M-37 Baldwin, Michigan 49304 Motel Office located 2 doors north of Motel location @ Baldwin Bait & Tackle on 9331 South M-37

RESTAURANTS LISTED ON BACK OF MAP

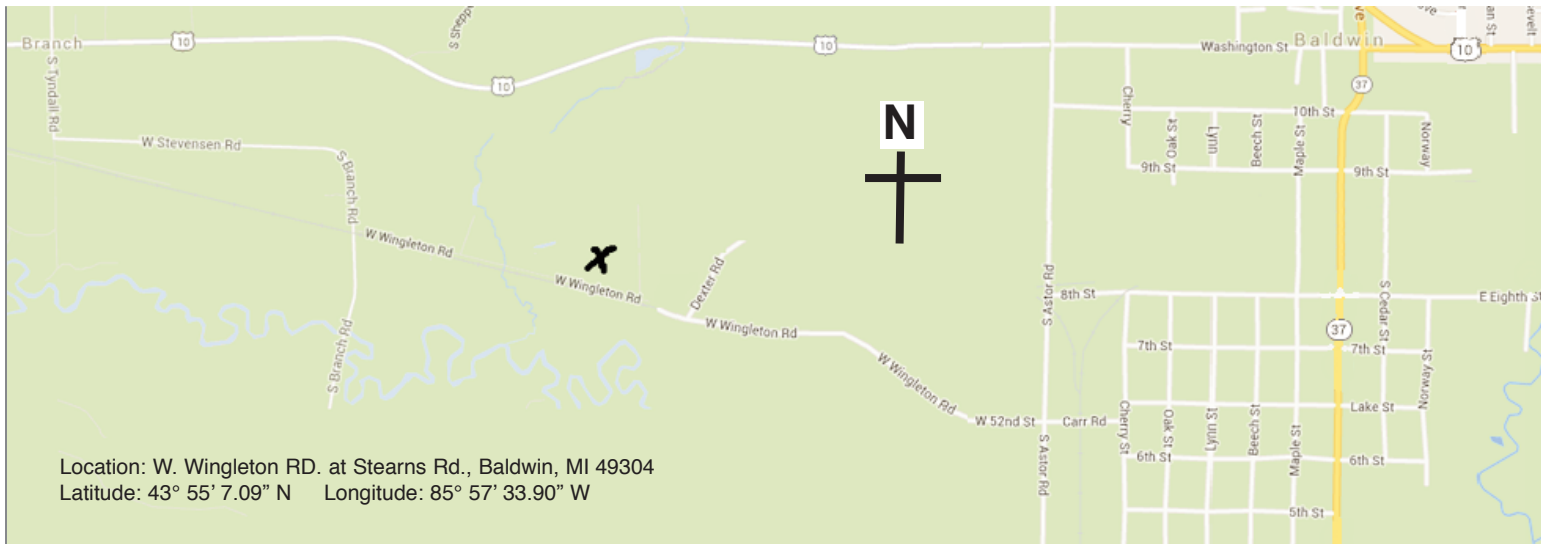

Location: W. Wingleton RD. at Stearns Rd., Baldwin, MI 49304
Latitude: 43° 55' 7.09" N Longitude: 85° 57' 33.90" W

Directions: 5.5 miles west of downtown Baldwin.
Follow signs for Rainbow Rapids Recreational Area.
Take W. Wingleton road to site, just past Dexter Road.

From M37, turn west onto 7th St. at the Wesco Gas Station.
Go five blocks to Cherry St. and turn left. Go to W. 52nd St. and turn right (this is the first right). Follow this 2-1/2 miles and veer right onto Wingleton Road (dirt road). Stay on Wingleton to the race site.

From West US 10, turn south on to Tyndall Rd. Go to Stevensen Rd and turn left. Follow to Wingleton Rd and turn left. Follow to race site.

There will be a **\$20 Event Fee** for the weekend.

A PARTIAL LIST OF RESTAURANTS ON M37

1. Barski
2. Debbie's Sportsmans Lounge
3. Village Restaurant
4. Northern Exposure Cafe
5. Pompeii's Pizza

RACE ENTRY FORM MUSH SWEETWATER CHALLENGE AT STEARNS SIDING SLED DOG RACE #2 FEBRUARY 6 - 7, 2021

FOR EACH RACE, please use a **separate entry** form and issue a **separate check** (please do not combine payment for several races on one check). If race is cancelled, checks will be destroyed unless otherwise noted.

NAME: _____ DAY PHONE: (____) _____
 ADDRESS: _____ EVENING PHONE: (____) _____
E-MAIL ADDRESS: _____ **CELL PHONE:** (____) _____
 CITY: _____ STATE: _____ ZIP CODE: _____

By signing, I/we agree that I/we will not hold Mid-Union Sled Haulers, Inc. (M.U.S.H.), the race sponsor, race organizing group or any of their employees, officers, agents or volunteers in any way liable or responsible for any injury to persons or property which may or might arise by virtue of my/our participation in these sled dog race events.

In addition, I/we accept full responsibility for the behavior of any minor children I/we may bring to this event.

I/We also agree to properly dispose of any and all refuse or litter generated by myself, family members, guests or dogs.

ALL DRIVERS MUST SIGN!

DATE

NEW PARTICIPANT RULE: All participants, **16 years or younger on the date of the race**, will be required to wear a well-fitting **SNOWBOARDING/SNOWSPORT approved helmet** for events.

LIST FULL NAMES OF ANY MINORS (under the age of 16) WHO ARE ENTERED IN EVENTS ON THIS FORM.
 (Please note that **M.U.S.H.** rules specify that sprint drivers must be at least 10 years of age and 1-Dog entrants must be at least 5 years of age, but not older than 11.)

NAME: _____ AGE _____ NAME: _____ AGE _____
 NAME: _____ AGE _____ NAME: _____ AGE _____

The above named minors have my permission to participate in the events they have entered.

Signed: _____ (must be signed by parent or guardian).

PLEASE ENTER DRIVER'S NAME OPPOSITE CLASS AND CHECK APPROPRIATE FEE BOX. STEARNS SIDING #1 SLED DOG RACE

Breed of Dogs: _____ **NOTE: Mixed Breed Teams will be classified as Alaskans.**

<u>DRIVER(S)</u>	<u>MEMBER FEE</u>	<u>NON-MEMBER FEE</u>
3 DOG CLASS: _____	\$10.00 [<input type="checkbox"/>]	\$15.00 [<input type="checkbox"/>]
3 DOG CLASS: _____	\$10.00 [<input type="checkbox"/>]	\$15.00 [<input type="checkbox"/>]
JUNIOR CLASS: (Age 10 - 15) _____	\$10.00 [<input type="checkbox"/>]	\$15.00 [<input type="checkbox"/>]
JUNIOR CLASS: (Age 10 - 15) _____	\$10.00 [<input type="checkbox"/>]	\$15.00 [<input type="checkbox"/>]
SENIOR DOG CLASS: (Dog Age 9+) _____	\$10.00 [<input type="checkbox"/>]	\$15.00 [<input type="checkbox"/>]
SENIOR DOG CLASS: (Dog Age 9+) _____	\$10.00 [<input type="checkbox"/>]	\$15.00 [<input type="checkbox"/>]
5 DOG CLASS: _____	\$10.00 [<input type="checkbox"/>]	\$15.00 [<input type="checkbox"/>]
5 DOG CLASS: _____	\$10.00 [<input type="checkbox"/>]	\$15.00 [<input type="checkbox"/>]
7 DOG CLASS: _____	\$10.00 [<input type="checkbox"/>]	\$15.00 [<input type="checkbox"/>]
7 DOG CLASS: _____	\$10.00 [<input type="checkbox"/>]	\$15.00 [<input type="checkbox"/>]
SKI-JORING 1 DOG: _____	\$10.00 [<input type="checkbox"/>]	\$15.00 [<input type="checkbox"/>]
SKI-JORING 1 DOG: _____	\$10.00 [<input type="checkbox"/>]	\$15.00 [<input type="checkbox"/>]
SKI-JORING 2 DOG: _____	\$10.00 [<input type="checkbox"/>]	\$15.00 [<input type="checkbox"/>]
SKI-JORING 2 DOG: _____	\$10.00 [<input type="checkbox"/>]	\$15.00 [<input type="checkbox"/>]
1-DOG CLASS: _____	NO FEE [<input type="checkbox"/>]	NO FEE [<input type="checkbox"/>]
1-DOG CLASS: _____	NO FEE [<input type="checkbox"/>]	NO FEE [<input type="checkbox"/>]

**COVID 19
 CHANGES**

**MUST
 WEAR
 MASKS**

**New Bib
 Number
 Handout
 procedure
 (as used in
 Wisconsin)**

EACH RACE ENTRY FORM MUST HAVE A SEPARATE CHECK!!!

Make checks payable to **M.U.S.H.** Check No.: _____ Amount enclosed \$ _____

IN THE EVENT OF RACE CANCELLATION, YOU CHOOSE: PLEASE CHECK CHOICE(S):

INTERESTED IN RACING AT AN ALTERNATE RACE SITE **INTERESTED IN MAKE-UP RACE ON MARCH 6-7, 2021**
 DONATE YOUR ENTRY FEE TO THE MUSH TREASURY **HAVE YOUR CHECK DESTROYED**