

Einsatz:

Spradow test couplings are applied for the monitoring and control pressure as well as the ventilation. The advantages of this system are – among other – connection at system pressure level, the easy connection to measurement control and switching devices, the leakproof connection.

Media:

Hydraulic oils and mineral based fluids.
(Please check compatibility of seal material.)

Materials:

Metal parts: Steel, Stainless steel upon request
Seals: NBR (-20 °C to +100 °C)
FKM (-20 °C to +200 °C)
EPDM (-40 °C to +150 °C)
Hose: polyamide (-35 °C to +100 °C)

Surface:

Zinc nickel, transparent, CrVI-free.

Pressure:

Maximum working pressure (PN) of the test couplings - 400 bar at 3-fold security. For the union pieces please observe the instructions given by the corresponding producer.

port connection and seals

type 1	type 2	type 3	type 4	type 5	type 6
Design types of port connection and seals please see annex.					

test coupling series Steck

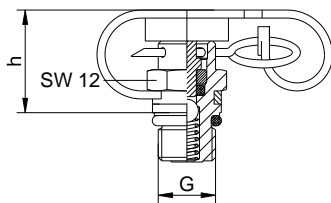

fig. 1

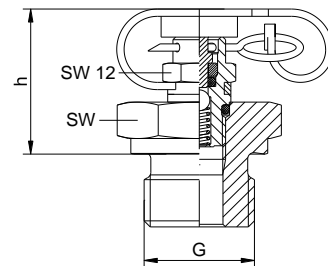

fig. 2

G	PN	SW	h	fig.	sealing	part number (NBR)	part number (FKM)
M8x1	250	-	18	1	o-ring type 1	1-900-20-21-180-CF	1-900-20-22-180-CF
M10x1	400	-	18	1	o-ring type 1	1-900-22-21-180-CF	1-900-22-22-180-CF
Rk 1/8*	400	-	18	1	thread type 4	1-900-33-00-180-CF	1-900-33-02-180-CF
1/8 NPT	-	-	18	1	thread type 4	1-900-43-00-180-CF	1-900-43-02-180-CF
M10x1		17	37	2	metallic sealing type 2	1-905-22-30-180-CF	1-905-22-32-180-CF
G 1/4		19	27	2	soft sealing type 3	1-905-29-11-180-CF	1-905-29-12-180-CF
G 1/4				2	metallic sealing type 2	1-905-29-30-180-CF	1-905-29-32-180-CF

*acc. DIN 3858

Other dimensions on request. We reserve the right to change the technical performance. All dimensions in mm.

fitting with test coupling series Steck

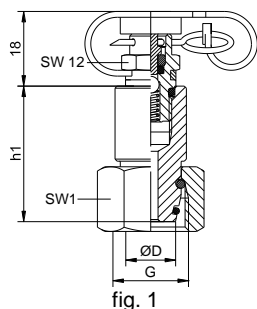

type DKO

test coupling with 24° taper adaptor (DIN3865 / ISO8434-1)

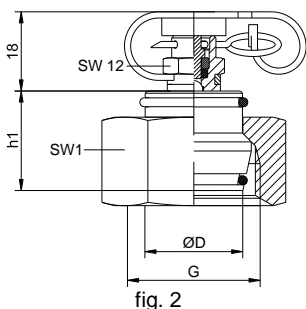

fig. 2

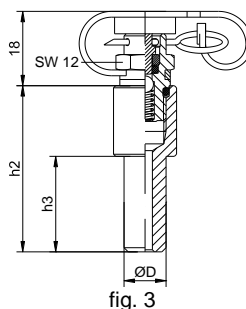

fig. 3

type BE

test coupling for compression ring fittings

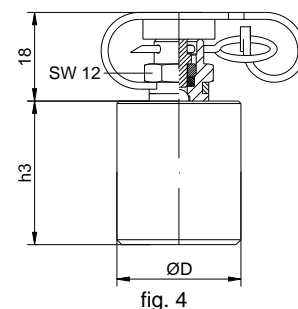

fig. 4

type	PN	tube ØD	h1	h2	h3	SW1	G	type DKO part number	fig.	type BE part number	fig.
L	315	6	33	38	20	14	M12x1,5	1-902-00-10-180-CF	1	1-903-00-00-181-CF	3
		8	33	38	20	17	M14x1,5	1-902-02-10-180-CF	1	1-903-02-00-181-CF	3
		10	33	40	22	19	M16x1,5	1-902-04-10-180-CF	1	1-903-04-00-181-CF	3
		12	33	40	22	22	M18x1,5	1-902-06-10-180-CF	1	1-903-06-00-181-CF	3
		15	20	-	28	27	M22x1,5	1-902-09-00-180-CF	2	1-903-09-00-181-CF	4
	160	18	22	-	28	32	M26x1,5	1-902-11-00-180-CF	2	1-903-11-00-181-CF	4
		22	22	-	30	36	M30x2	1-902-13-00-180-CF	2	1-903-13-00-181-CF	4
		28	24	-	32	41	M36x2	1-902-15-00-180-CF	2	1-903-15-00-181-CF	4
		35	27	-	42	50	M45x2	1-902-17-00-180-CF	2	1-903-17-00-181-CF	4
		42	28	-	45	60	M52x2	1-902-19-00-180-CF	2	1-903-19-00-181-CF	4
S	400	6	34	38	20	17	M14x1,5	1-902-01-10-180-CF	1	1-903-00-00-181-CF	3
		8	34	38	20	19	M16x1,5	1-902-03-10-180-CF	1	1-903-02-00-181-CF	3
		10	34	40	22	22	M18x1,5	1-902-05-10-180-CF	1	1-903-04-00-181-CF	3
		12	34	40	22	24	M20x1,5	1-902-07-10-180-CF	1	1-903-06-00-181-CF	3
		14	20	40	22	27	M22x1,5	1-902-08-00-180-CF	2	1-903-08-00-181-CF	3
	400	16	20	-	28	30	M24x1,5	1-902-10-00-180-CF	2	1-903-10-00-181-CF	4
		20	25	-	30	36	M30x2	1-902-12-00-180-CF	2	1-903-12-00-181-CF	4
		25	27	-	36	46	M36x2	1-902-14-00-180-CF	2	1-903-14-00-181-CF	4
		30	29	-	41	50	M42x2	1-902-16-00-180-CF	2	1-903-16-00-181-CF	4
		315	38	32	-	48	60	M52x2	1-902-18-00-180-CF	2	1-903-18-00-181-CF

Design with sealings made of FKM

replace 00-180 by 02-180 or
10-180 by 12-180

replace 00-181 by 02-181

90° fitting type BE with test coupling series Steck

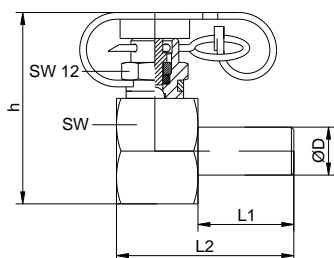

tube ØD	L1	L2	SW	h	part number (NBR)	part number (FKM)
8	20	37	22	40	1-980-03-20-080-CF	1-980-03-20-081-CF
10	20	37	22	40	1-980-05-20-120-CF	1-980-05-20-121-CF

Other dimensions on request. We reserve the right to change the technical performance. All dimensions in mm.

fitting with test coupling series Steck

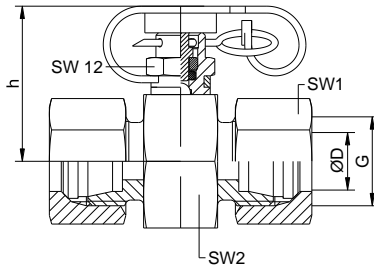

type GE

(DIN2353 / ISO8434-1 and -4)

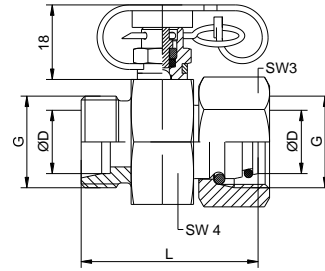

type DKOGE

(DIN2353 / ISO8434-1 and -4)

type	PN	tube ØD	G	SW1	SW2	h	L	SW3	SW4	type GE part number	type DKOGE part number
L	315	6	M12x1,5	14	22	29	43	14	24	1-904-00-00-180-CF	1-904-20-00-181-CF
		8	M14x1,5	17	24	30	43	17	24	1-904-02-00-180-CF	1-904-22-00-181-CF
		10	M16x1,5	19	24	30	45	19	24	1-904-04-00-180-CF	1-904-24-00-181-CF
		12	M18x1,5	22	27	32	41	22	27	1-904-06-00-180-CF	1-904-26-00-181-CF
		15	M22x1,5	27	30	33	43	27	30	1-904-09-00-180-CF	1-904-29-00-181-CF
		18	M26x1,5	32	32	34	54	32	32	1-904-11-00-180-CF	1-904-31-00-181-CF
	160	22	M30x2	36	36	36	57	36	36	1-904-13-00-180-CF	1-904-33-00-181-CF
		28	M36x2	41	41	39		upon request		1-904-15-00-180-CF	1-904-35-00-181-CF
		35	M45x2	50	46	41		upon request		1-904-17-00-180-CF	1-904-37-00-181-CF
		42	M52x2	60	55	46		upon request	1-904-19-00-180-CF	1-904-39-00-181-CF	
S	630	6	M14x1,5	17	24	30	46	17	24	1-904-01-00-180-CF	1-904-21-00-181-CF
		8	M16x1,5	19	24	30	47	19	24	1-904-03-00-180-CF	1-904-23-00-181-CF
		10	M18x1,5	22	24	30	48	22	24	1-904-05-00-180-CF	1-904-25-00-181-CF
		12	M20x1,5	24	24	30	47	24	24	1-904-07-00-180-CF	1-904-27-00-181-CF
		14	M22x1,5	27	27	32	50	27	27	1-904-08-00-180-CF	1-904-28-00-181-CF
	400	16	M24x1,5	30	30	33	55	30	30	1-904-10-00-180-CF	1-904-30-00-181-CF
		20	M30x2	36	32	34	62	36	36	1-904-12-00-180-CF	1-904-32-00-181-CF
		25	M36x2	46	41	39	62	46	41	1-904-14-00-180-CF	1-904-34-00-181-CF
		30	M42x2	50	46	41		upon request		1-904-16-00-180-CF	1-904-36-00-181-CF
315	38	M52x2	60	55	46		upon request	1-904-18-00-180-CF	1-904-38-00-181-CF		

Design with sealings made of FKM replace 00-180 by 02-180 replace 00-181 by 02-181

bulkhead connector series Steck

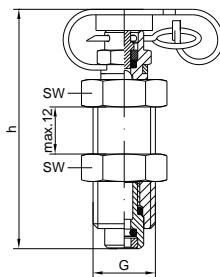

fig. 1

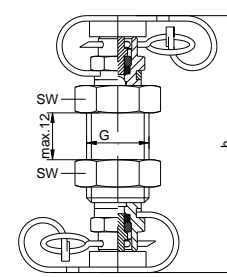
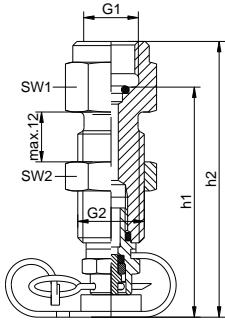

fig. 2

G	SW	h	fig.	part number (NBR)	part number (FKM)
M16x2	19	61	1	1-980-48-20-040-CF	1-980-48-20-041-CF
M16x2	19	71	2	1-980-48-20-050-CF	1-980-48-20-051-CF

Other dimensions on request. We reserve the right to change the technical performance. All dimensions in mm.

bulkhead pressure gauge connector series Steck – without valve function



G1	SW1	SW2	h1	h2	G2	sealing	part number (NBR)	part number (FKM)
G 1/4	19	19	55	66	M16x2	o-ring	1-918-29-01-210-CF	1-918-29-21-210-CF
G 1/2	27	24	58	75	M16x2	o-ring	1-918-31-01-210-CF	1-918-31-21-210-CF
1/4 NPT	19	19	-	68	M16x2	thread	1-918-44-00-210-CF	1-918-44-20-210-CF
1/2 NPT	27	24	-	75	M16x2	thread	1-918-46-00-210-CF	1-918-46-20-210-CF

high pressure hose series Steck

Max. working pressure:
up to 630 bar

Pressure / t° factor:
at 20°C 100%
at 40°C 95%
at 60°C 90%
at 80°C 80%
at 100°C 70%

Further details please see
section hoses and con-
nectors

series Steck

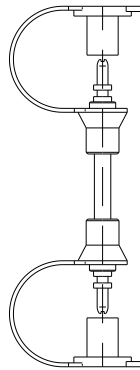

series Steck

series Steck

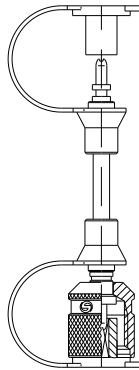

series M16x2

series Steck

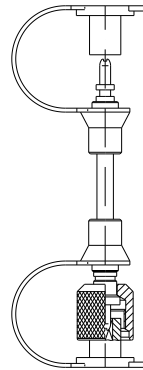

series S12x1,5

series Steck

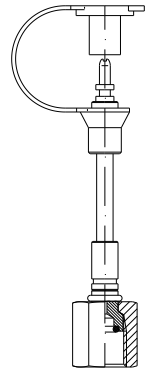

pressure gauge
connector G 1/4²⁾

length L ¹⁾ acc. DIN 20066	part number			
200	1-971-01-01-010-CF	1-971-01-04-010-CF	1-971-01-12-010-CF	1-971-01-02-010-CF
400	1-971-01-01-040-CF	1-971-01-04-040-CF	1-971-01-12-040-CF	1-971-01-02-040-CF
630	1-971-01-01-060-CF	1-971-01-04-060-CF	1-971-01-12-060-CF	1-971-01-02-060-CF
800	1-971-01-01-080-CF	1-971-01-04-080-CF	1-971-01-12-080-CF	1-971-01-02-080-CF
1000	1-971-01-01-090-CF	1-971-01-04-090-CF	1-971-01-12-090-CF	1-971-01-02-090-CF
1500	1-971-01-01-100-CF	1-971-01-04-100-CF	1-971-01-12-100-CF	1-971-01-02-100-CF
2000	1-971-01-01-110-CF	1-971-01-04-110-CF	1-971-01-12-110-CF	1-971-01-02-110-CF
2500	1-971-01-01-120-CF	1-971-01-04-120-CF	1-971-01-12-120-CF	1-971-01-02-120-CF
3200	1-971-01-01-130-CF	1-971-01-04-130-CF	1-971-01-12-130-CF	1-971-01-02-130-CF
4000	1-971-01-01-140-CF	1-971-01-04-140-CF	1-971-01-12-140-CF	1-971-01-02-140-CF

¹⁾ Other lengths upon request

Further connectors please see chapter
hoses and connectors

²⁾ Connection thread G¹/₂,
¹/₄ NPT and ¹/₂ NPT upon request.

The information on the definition of the hose assembly lengths, please see the annex.