



## BEx-Solution

innovative Ex Remote IO modules with bus-coupling

## FESTO

tried-and-tested Ex i valve terminal

## Exepd

certified system-integration in Ex e field enclosure

Tested system solution from



The 3 in 1 solution, provides plant and machine manufacturer for the first time a decentralized and compact solution to control pneumatic actuators for the hazardous area **Zone 1/21**

## Customer benefit

- **Compact - Simple - Fast**
  - ✓ Central Ethernet connection, central pneumatic connection
  - ✓ Easy decentralized installation - guarantees short distance to sensors and pneumatic actuators.
  - ✓ No compressed air tubing inside the box
  - ✓ Cost savings and less installation effort

## Application

- Paint shops
- Pharmaceutical plants
- Bulk materials handling systems
- Mixing / grinding plants
- Industrial heating / cooling systems
- Sewage treatment plants
- And much more

## Function

- 8 outputs to 8 valves 3/2 way pre-wired
- 16 Namur inputs for position feedback
- 8 additional channels individually adjustable (AI, AO or DO or switch mode)

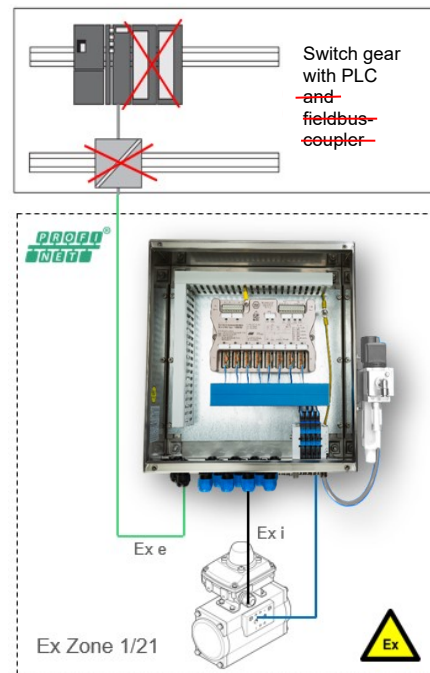

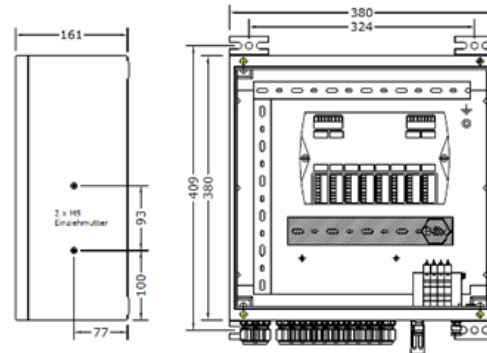
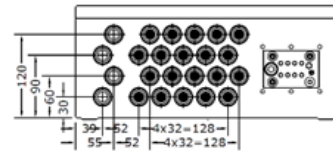
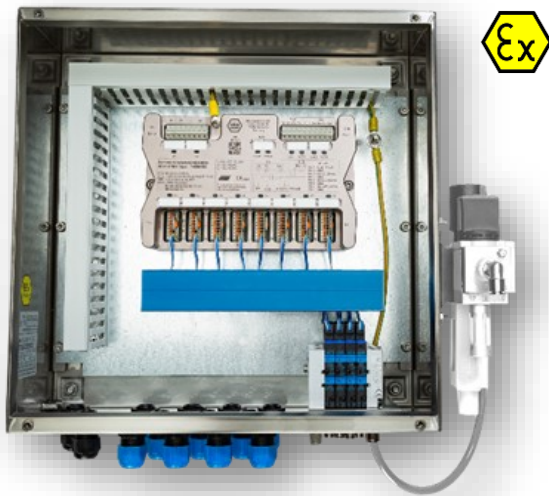

## Type A21-E4-03821

Order code 218757

8 DO to 8 valves 3/2-way pre-wired  
 16 Namur inputs  
 8 additional channels individually adjustable as AI, AO or DO or switch mode

### Design:

Ex e enclosure IP65 Stainless steel 1.4404 (V4A)

Dimension: 380 x 380 x 161 mm

Ambient temperature: -5°C bis +40°C

Certificate: TPS 07 ATEX 61951 1

Type of protection: II 2(1)G/D

Ex e mb ib [ia Ga] IIC T4 Gb

Ex tb [ia Da] IIIC T80°C Db

4 cable glands M20x1,5 (Ex e) 4-13 mm

20 cable glands M20x1,5 (Ex i) 4-13 mm

(all cable glands are closed with mushroom caps)

4 wall mounting bracket

2 pull in nuts M5 (mounting for optional Festo service unit combination MSB4)

1 BEx1 remote IO Module Profinet type 14200101 (Alternative Modbus TCP/IP)

1 Festo valve terminal CPV10 Ex i with aluminum multipole Typ 10P-10-4A-IC-R-Y-4CY-EX3+GQCA

Equipped with 4 x CY 2x3/2 valves, normally closed, with integrated back pressure protection

Optional: shield rail with shield connection clamp or EMC cable glands on request

Country of origin: DE ; Customs tariff number: 8537 1098

Remark: When using the Ex e cover caps (accessory), the Ex e enclosure may be opened while energized, provided that there are no other open Ex e connections in the enclosure.

## BEx1 Remote IO module

- include busnode, isolating amplifier and intrinsically safe IO channels  
[Link to data sheet](#)

## Festo valve terminal

The valve terminal CPV10-EX-VI is intrinsically safe

II 2G Ex ib IIC T4 (-5°C\* ≤ Ta ≤ 50°C) \*Pressure dew point: -15 C, alternatively class x:3:x according to ISO 8573-1: 2010

- Pneumatic aluminum multipole, enclosure type IP65
- Valve width 10 mm breit, Flow rate 400 l/min
- Operating pressure: 0 ... 10 bar ; Pilot pressure: 3 ... 8 bar
- 4 valve discs with valve 2x 3/2- way (further variants on request)
- Manual override detenting

[Link to data sheet](#)