

BIKE ACCESSORIES - WHEELED GOODS GENERIC PROGRAM AND LICENSES

2024

SKIDS CONTROL®

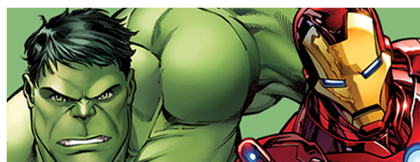

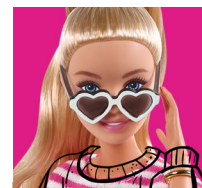
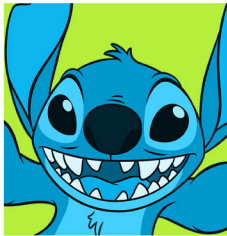

Stamp is specialised in outdoor products. Since 1994 we have had a long and successful history with different licensors and have created the best designs, All covering some very successful characters and brands.

Stamps service to the Industry is second to none, we believe in improving the lives of children and seeing them laugh. We have a stringent quality control program and all our products substantially apply to the essential safety standards.
At Stamp we never compromise on quality.

From the embryonic stages of design through to full production we take great care to produce only the very best. Our service to the Industry these past 30 years has been rewarded with the constant support of our customers, their loyalty, and of course the satisfaction of the consumers.

Visit our website :
[www. stamp-france.fr](http://www.stamp-france.fr)

La société STAMP se réserve le droit de modifier sans préavis les caractéristiques des articles présentés dans ce catalogue.
Photos non - contractuelles.
The compagny STAMP reserves the right to modify without prior notice the items' specifications presented in this catalogue.
Pictures not contractual.



MAIN RANGE-----P4



LIGHTNING RANGE-----P28



KHAKI RANGE-----P36



CARBONE RANGE-----P40



OXYGEN RANGE-----P50



-----P56



-----P63



-----P67



-----P70



-----P74



-----P79



-----P85



-----P88



-----P93

Play time Mickey -----P99



-----P101



-----P104



-----P108



-----P114

GENERIC PROGRAM



INNOVATION
QUALITY
STYLE
DESIGN



BABY WALKER - JS123250

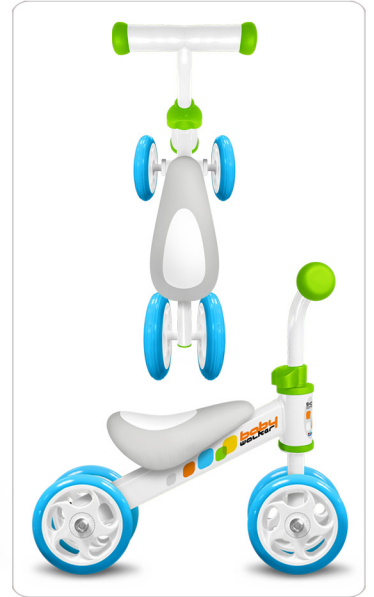

- Adjustable handlebar.
- Anti-pinch EVA grips.
- Limitation of the steering angle.
- Stimulates and helps to learn the balance.
- Easy and quick to assemble
- 4 wheels Baby walker ride on.
- Steel Frame, close to the bottom for safety and easy to climb on it.
- 4 big PVC wheels for a better stability.
- Large Foam saddle for comfort and safety.

BABY WALKER - JS123251

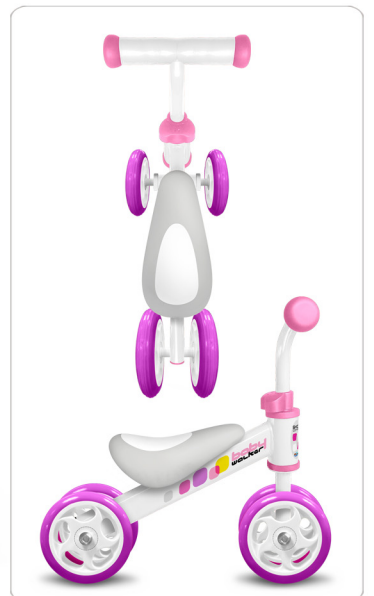



C677008

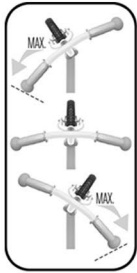

- STEEL FRAME
- EVA TYRES
- ABEC 5 BEARINGS
- SADDLE & HANDLE BAR AJUSTABLE
- FOAM SADDLE
- STEERING STOP
- FULL COLOR PACKAGING

C677009





C677006

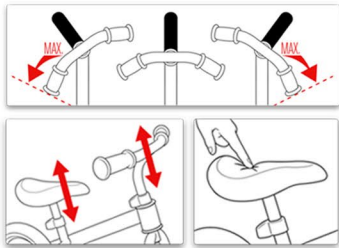

- STEEL FRAME
- EVA TYRES
- ABEC 5 BEARINGS
- SADDLE & HANDLE BAR AJUSTABLE
- FOAM SADDLE
- STEERING STOP
- FULL COLOR BOX PACKAGING

C677007

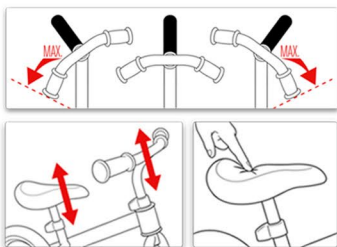

- PRODUCT SIZES: 80 X 41 X 58CM
- FRAME: STEEL & PLASTIC
- T-BAR: STEEL
- WHEEL: 10" EVA TYRES
- SADDLE & HANDLE BAR AJUSTABLE
- FOAM SADDLE
- STEERING STOP
- LARGE FOOT DECK
- U FRAME: EASY TO CLIMB OVER
- ABEC 5 STEEL BALL BEARINGS
- FULL COLOR BOX PACKAGING



C677010



- STEEL FRAME
- WHEEL: 9" EVA TYRES
- ABEC 5 BEARINGS
- SADDLE & HANDLE BAR ADJUSTABLE
- FOAM SADDLE
- STEERING STOP
- MAT FINISH
- FULL COLOR BOX PACKAGING

C677011





J679001



- ADJUSTABLE SEAT
- STEEL FRAME
- HAND BRAKE
- PP WHEELS: 190mm DIAMETER



ADJUSTABLE HEIGHT

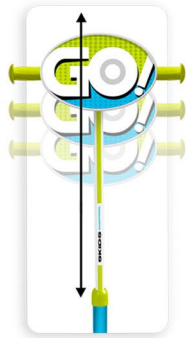

ANTI SLIP DECK



JS123003



ADJUSTABLE HEIGHT



ANTI SLIP DECK



JS123004





JS123005

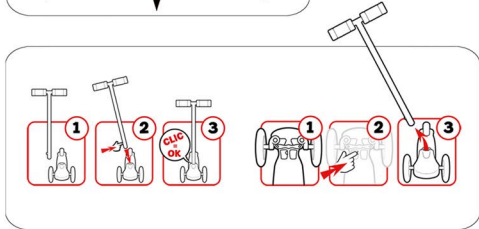
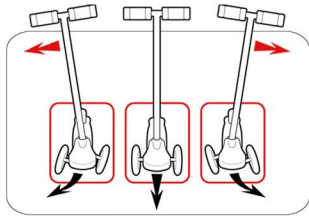

ANTI SLIP DECK



REAR BRAKE



ABEC 5 BEARING
MAX. WEIGHT: 20 KG

JS123006

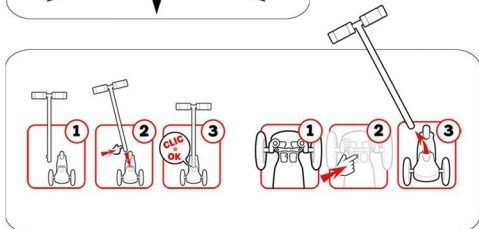
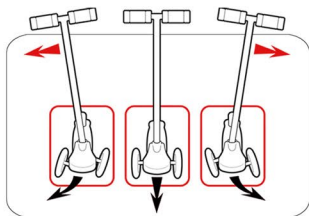

ANTI SLIP DECK



REAR BRAKE



ABEC 5 BEARING
MAX. WEIGHT: 20 KG



JS123001



- 120 mm - PVC WHEELS
- ABEC 5 BEARINGS
- MAX. WEIGHT: 50 Kg



JS123002



- 120 mm - PVC WHEELS
- ABEC 5 BEARINGS
- MAX. WEIGHT: 50 Kg





FOLDABLE SCOOTER with SPEEDOMETER

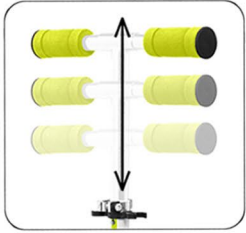

- 120 mm - PVC WHEELS
- ABEC 5 BEARINGS
- MAX. WEIGHT: 50 Kg

JS123008

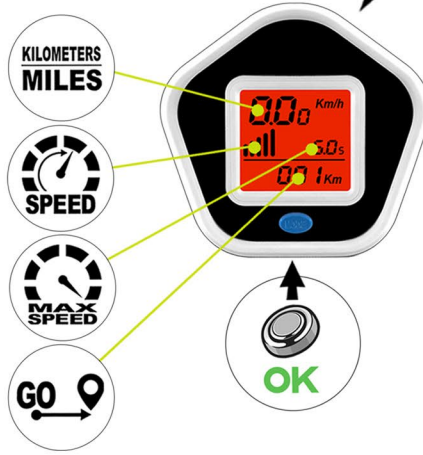



- FOLDABLE SCOOTER
- SAFE FOLDING MECHANISM
- ABEC 5 BALL BEARING
- REAR FOOT BRAKE
- ADJUSTABLE HEIGHT
- NON SLIP PP DECK HIGH RESISTANCE
- PVC ANTI PINCH GRIPS

JS123010



JS123011





JS123700

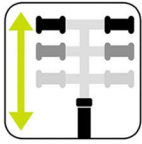

TECHNICAL DETAILS:

- PU WHEELS
- ABEC 5 BEARINGS
- ALUMINIUM & STEEL FRAMES & TUBES
- LARGE DECK SIZE
- MAX. WEIGHT: 100 KGS
- WIDE ANTI SLIP TRAY
- HEIGHT ADJUSTABLE HANDLES





JB200001



- REAR BRAKE
- BEARING ABEC 5
- PU WHEELS: 200 MM
- DECK ALUMINIUM: 520/98 MM
- EXTRA LOW DECK FOR HIGHER PERFORMANCE & BETTER COMFORT
- MAX. WEIGHT: 100 KGS
- EN 14619 STANDARD



JB200002



- REAR BRAKE
- BEARING ABEC 5
- PU WHEELS: 200 MM
- DECK ALUMINIUM: 520/98 MM
- EXTRA LOW DECK FOR HIGHER PERFORMANCE & BETTER COMFORT
- MAX. WEIGHT: 100 KGS
- EN 14619 STANDARD





JB325001

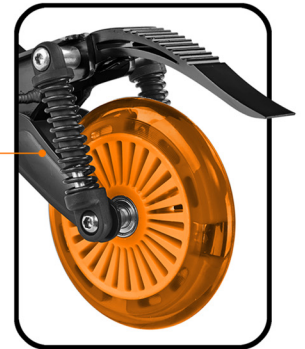
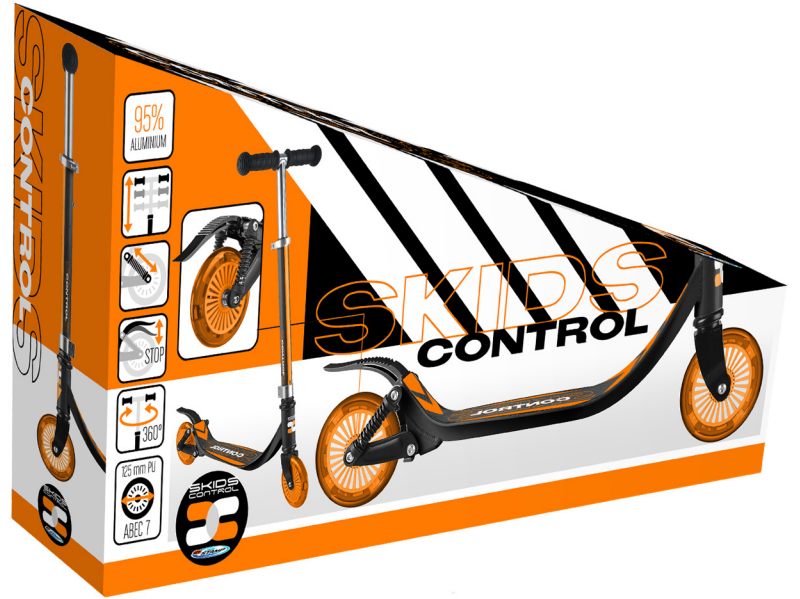
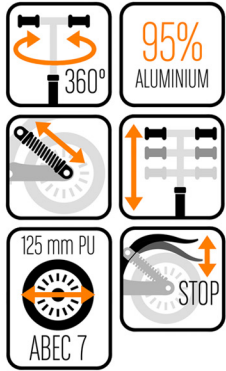

- 360 DEGREE HANDLE ROTATION WHICH HANDLES LIKE STUNT SCOOTER AERODYNAMIC DECK WITH BUILT IN SUSPENSION
- BACK WHEEL HAS DOUBLE SUSPENSION
- REAR BRAKE
- PRODUCT SIZES: 66,5 - 27,5 - 76 CM
- BODY MAIN MATERIAL: ALUMINIUM
- T-BAR WITH RUBBER HANDLE BAR
- 125MM PU WHEELS
- BEARINGS: ABEC 7
- DECK SIZES: 110 / 420MM



JS123180

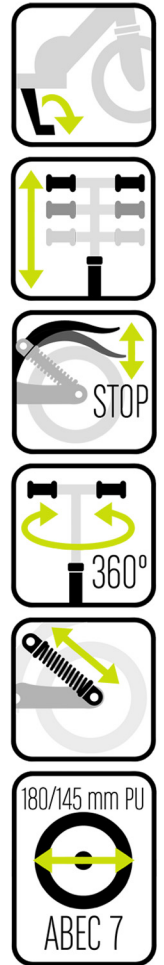

- T-BAR 360° ROTATION
- ADJUSTABLE T-BAR
- 180 & 145 mm PU WHEELS
- BEARING ABEC 7
- DECK SIZE 110/460 mm
- ALLOY DECK
- HANDLE GRIP TPR
- KICKSTAND
- REAR WHEEL WITH DOUBLE SUSPENSION
- REAR BRAKE
- ERGONOMIC SHAPE
- MAX. WEIGHT 100 Kgs
- EN 14619 STANDARD





JB246001



- - Steel alloy Bar; with an innovative cross-bar design and have 2 degrees of sweepback.
- - Pro Double Scooter Clamp made From 6061 aluminium.
- - Headset For threaded Forks. Steel cups offer long life along with caged bearings for a smooth ride.
- - Reinforced steel alloy threaded Fork.
- - Extra strength Nylon mix Fiber Core, 88A PU cast wheels, ABEC-5 bearings. Size : 100*24 mm.
- - 6061 Aluminium Extrusion Deck, 490*100 deck with Full griptape.
- - Steel alloy quick stop brake.

The Stunt Scooter is the obvious choice for older kids who enjoy riding Scooters but want to get a new riding Feeling and experience new moves. More technical, with a more mature look, the Stunt Scooter is becoming trendy and a « must have » item.



JB247001





COMBO ROLLER SKATING SET

(Sizes: 23-27)

JS680035



QUICK & EASY ADJUSTMENT
EN14120 + A1 : 2007 / RANGE A LEVEL 1
25 KG MAX.

QUICK AND EASY ADJUSTMENT

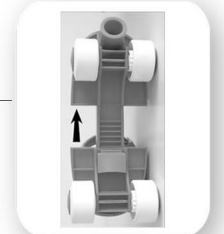

EN71 / 20 KG MAX.

JS670035



QUICK & EASY ADJUSTMENT
EN14120 + A1 : 2007 / RANGE A LEVEL 1
25 KG MAX.

QUICK AND EASY ADJUSTMENT

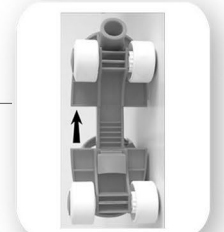

EN71 / 20 KG MAX.



PUSH BUTTON FOR A QUICK AND EASY ADJUSTMENT



MAX. WEIGHT: 20 Kg

SIZE ADJUSTMENT



TRISKATES TO IN LINES



4 SIZES ADJUSTMENT

SIZE	BOY	GIRL
27/30	3-7 YEARS	4-7 YEARS
30/33	5-9 YEARS	6-10 YEARS
34/37	8-10 YEARS	8-12 YEARS

PUSH BUTTON FOR A QUICK AND EASY ADJUSTMENT



MAX. WEIGHT: 20 Kg

SIZE ADJUSTMENT



TRISKATES TO IN LINES



JS680301 (Sizes: 27-30)



JS670301 (Sizes: 27-30)





BEARING 608Z
MAX. WEIGHT: 60 Kg

SIZE ADJUSTMENT

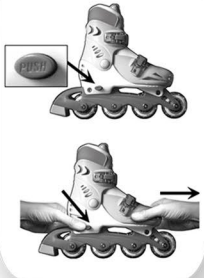

PUSH BUTTON FOR A
QUICK AND EASY ADJUSTMENT



JB130230 (Sizes: 30-33)



4 SIZES ADJUSTMENT

SIZE	BOY	GIRL
27/30	3-7 YEARS	4-7 YEARS
30/33	5-9 YEARS	6-10 YEARS
34/37	8-10 YEARS	8-12 YEARS

BEARING 608Z
MAX. WEIGHT: 60 Kg

SIZE ADJUSTMENT

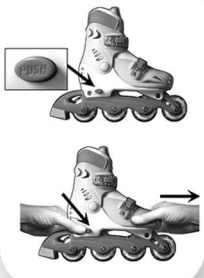

PUSH BUTTON FOR A
QUICK AND EASY ADJUSTMENT



JB130130 (Sizes: 30-33)





Approximate sizes: 53-56 cm
FOAM PADS
CE - EN1078 + A1 : 2012

C680061



JS680110S



K680507

Approximate sizes: 53-56 cm
FOAM PADS
CE - EN1078 + A1 : 2012
HEAD RING ADJUSTMENT SYSTEM

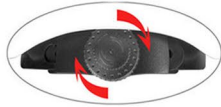

— QUICK & EASY ADJUSTMENT
EN14120 + A1 : 2007 / RANGE A LEVEL 1
25 KG MAX.

PACKAGING WHICH ALLOWS
CONSUMER TO TRY THE HELMET
ELBOW & KNEE PADS ARE
PROTECTED UNDER A BLISTER





Approximate sizes: 53-56 cm
FOAM PADS
CE - EN1078 + A1 : 2012



C670061



JS670110S



K670507

Approximate sizes: 53-56 cm
FOAM PADS
CE - EN1078 + A1 : 2012
HEAD RING ADJUSTMENT SYSTEM

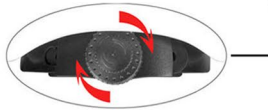

PACKAGING WHICH ALLOWS
CONSUMER TO TRY THE HELMET
ELBOW & KNEE PADS ARE
PROTECTED UNDER A BLISTER



— QUICK & EASY ADJUSTMENT
EN14120 + A1 : 2007 / RANGE A LEVEL 1
25 KG MAX.



JS100310
(22" x 6")



BOTTOM VIEW



HANDLE

HANGER

- SKATE BOARD 22" x 6"
- PP (Polypropylene) deck high resistance
- Anti slip deck
- Aluminium truck
- PVC wheels 60x45mm
- ABEC 5 bearings
- Carrying handle
- Printed deck

TOP VIEW



JS102310
(28" x 8")



- SKATE BOARD 28" x 8"
- ANTI SLIP DECK
- DOUBLE KICK
- TRUCK PP HIGH RESISTANCE
- PVC WHEELS 50MM
- 60BZ BEARINGS
- PRINTED DECK ON TWO SIDES
- 9 CHINESE MAPLE LAYERS
- WITH HANGER



JS104310
(41" x 9")



TOP VIEW

- LONGBOARD 41" x 9" (103 CM X 23,5 CM)
- TRUCK 7" ALUMINIUM HIGH RESISTANCE
- PU WHEELS 60 X 45 MM
- ABEC 7 BEARING
- PRINTED ANTI SLIP DECK

WITH HANGER

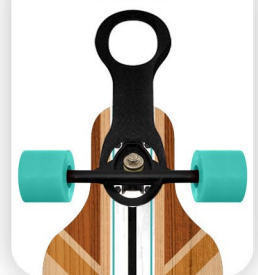



JH674112



TECHNICAL DETAILS:
- BLACK EPS
- FOAM PAD INCLUDED
- ABS SHELL
- 53-57 CM
- HEAD RING
ADJUSTMENT SYSTEM

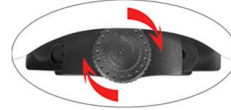

JH674102



TECHNICAL DETAILS:
- BLACK EPS
- FOAM PAD INCLUDED
- ABS SHELL
- 53-57 CM
- HEAD RING
ADJUSTMENT SYSTEM

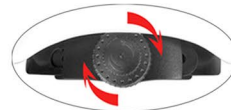

FACING EXAMPLES



LIGHTNING RANGE



INNOVATION
QUALITY
STYLE
DESIGN

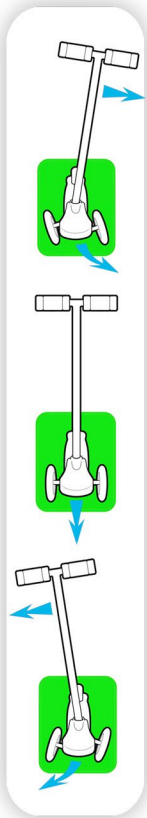

- 2 LIGHTNING WHEELS

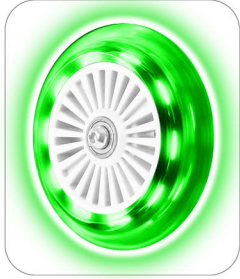

- ANTI SLIP DECK
- REAR BRAKE
- ABEC 5 BEARING
- MAX. WEIGHT: 20 KGS

JS123045L

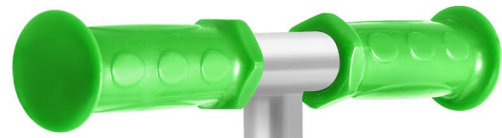

OXELO SKIDS CONTROL





- LIGHTNING WHEELS

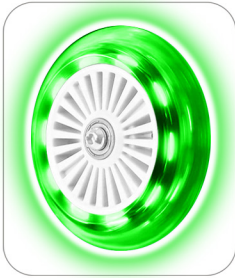

- SAFE FOLDING MECHANISM
- ABEC 5 BEARING
- REAR BRAKE
- ADJUSTABLE HEIGHT
- ANTI SLIP PP DECK HIGH RESISTANCE
- PVC ANTI PINCH GRIPS



JS123043L





JB248001L



100 Kg MAX.



LIGHTNING WHEELS



- Steel alloy Bar, with an innovative cross-bar design and have 2 degrees of sweepback.
- Pro Double Scooter Clamp made From 6061 aluminium.
- Headset For threaded Forks. Steel cups offer long life along with caged bearings For a smooth ride.
- Reinforced steel alloy threaded Fork.
- Extra strength Nylon mix Fiber Core, 88A PU cast wheels, ABEC-5 bearings. Size : 100*24 mm.
- 6061 Aluminium Extrusion Deck, 490*100 deck with Full griptape.
- Steel alloy quick stop brake.





JS123355L

- LIGHTNING WHEELS



- PP FRAME
- PVC WHEELS SIZE 70 X 24 MM WITH LEDS
- ABEC 5 BEARING
- EACH SET DELIVERED WITH 2L KEY FOR SIZE ADJUSTMENT
- MAX. 50 KGS
- AGE: 6+





JS123302L
(SIZES: 30-33)



LIGHTNING WHEELS

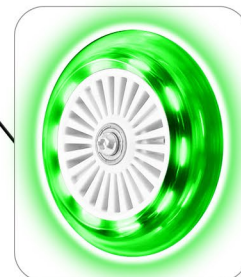

BEARING 608Z
MAX. WEIGHT: 60 Kg

SIZE ADJUSTMENT

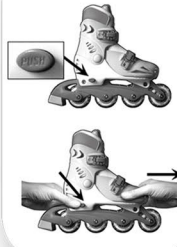

PUSH BUTTON FOR A
QUICK AND EASY ADJUSTMENT



4 SIZES ADJUSTMENT

SIZE	BOY	GIRL
27/30	3-7 YEARS	4-7 YEARS
30/33	5-9 YEARS	6-10 YEARS
34/37	8-10 YEARS	8-12 YEARS





JS123310L

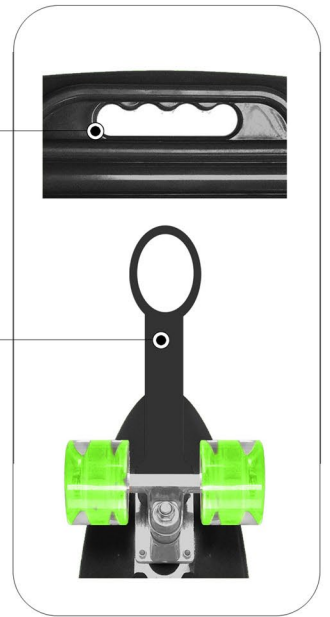

- LIGHTNING WHEELS



- SKATEBOARD 24" X 7"
- PP (POLYPROPYLENE) DECK HIGH RESISTANCE
- ANTI SLIP DECK
- ALUMINIUM TRUCK
- PU WHEELS 60 X 45 MM
- ABEC 7 BEARING
- CARRYING HANDLE
- PRINTED DECK



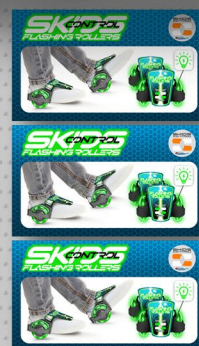

DISPLAY EXAMPLE

KHAKI RANGE



INNOVATION
QUALITY
STYLE
DESIGN



JB247001



TECHNICAL DETAILS:

- Stunt Scooter
- Steel alloy reinforced Frame
- 100mm PU wheels
- ABEC5 Bearings
- Double Clamp
- BMX Fork style
- Rear Foot brake



100 Kg MAX.





JS101310

- SKATE BOARD 24" x 7"
- PP (Polypropylene) deck high resistance
- Anti slip deck
- Aluminium truck
- Transparent PU wheels 60x45mm
- ABEC 7 bearings
- Carrying handle
- Printed deck



JH123102



- TECHNICAL DETAILS:
- BLACK EPS
 - FOAM PAD INCLUDED
 - ABS SHELL
 - 53-57 CM
 - HEAD RING ADJUSTMENT SYSTEM

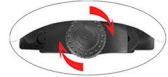



DISPLAY EXAMPLE

CARBONE RANGE



INNOVATION
QUALITY
STYLE
DESIGN

JK525145



-
-
-
-
-
-
-

T-BAR 360° ROTATION
ADJUSTABLE T-BAR
145 mm PU WHEELS
BEARING ABEC 7
DECK SIZE 110/460 mm
ALLOY DECK
HANDLE GRIP TPR

KICKSTAND
REAR WHEEL WITH
DOUBLE SUSPENSION
REAR BRAKE
ERGONOMIC SHAPE
MAX. WEIGHT 100 KGS
EN 14619 STANDARD

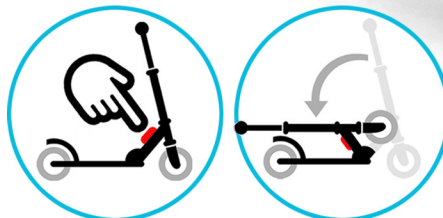

JK525200

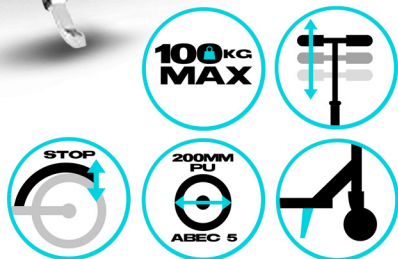

- TPR GRIP
- REAR BRAKE
- BEARING ABEC 5
- PU WHEELS 200 MM
- DECK ALUMINIUM 520/98 MM
- EXTRA LOW DECK FOR HIGHER PERFORMANCE & BETTER COMFORT
- MAX. WEIGHT 100 KGS
- EN 14619 STANDARD



JK525801



- Pro TRIPLE Scooter Clamp made From 6061 aluminium.
- Headset For threaded Forks. Steel cups offer long life along with caged bearings For a smooth ride.
- Reinforced steel alloy threaded Fork.
- Extra strength Nylon mix Fiber Core, 88A PU cast wheels, ABEC-5 bearings. Size : 100*24 mm.
- 6061 Aluminium Extrusion Deck, 480*100 deck with Full griptape.
- Steel quick stop brake.

JK525315



- 1- 100% Steel
 - 2- Grip: Rubber
 - 3- Deck: PP
 - 4- Stem: steel
 - 5- Handle bar: steel
 - 6- Connector: steel
 - 7- Front Fork: steel
 - 8- Brake: steel
 - 9- Wheel: PU wheel, 120* 24 mm
- Remarks: Brake on Front wheel



JK525302 (SIZES 34-37)

- In line skates semi soft
- Adjustable size 34 - 37
- PU Wheels
- Bearing ABEC 7
- Aluminium chassis
- Push button for a quick and easy adjustment
- Safety buckle



MAX. WEIGHT: 60 Kg

SIZE ADJUSTMENT



PUSH BUTTON FOR A QUICK AND EASY ADJUSTMENT



4 SIZES ADJUSTMENT

SIZE	BOY	GIRL
27/30	3-7 YEARS	4-7 YEARS
30/33	5-9 YEARS	6-10 YEARS
34/37	8-10 YEARS	8-12 YEARS





JK525310

SKATEBOARD 31" X 8"
ANTI SLIP DECK
DOUBLE KICK CONCAVE BOARD
TRUCK ALUMINIUM
PU WHEELS
ABEC 5 BEARING
PRINTED DECK ON TWO SIDES
8 CHINESE MAPLE LAYERS
WITH HANGER

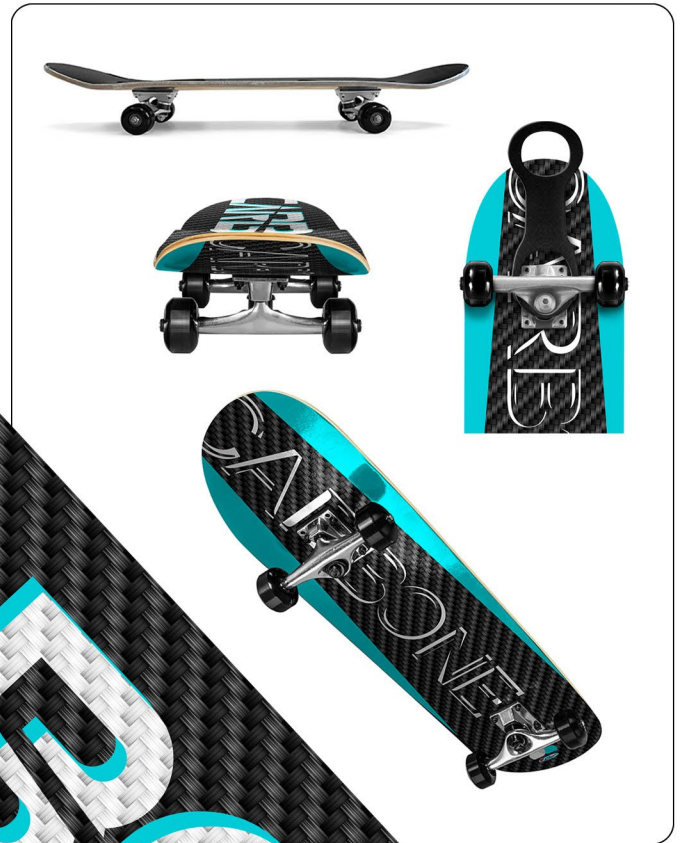



JK525102



BLACK EPS
FOAM PAD INCLUDED
ABS SHELL
53 - 57 CM
HEAD RING ADJUSTMENT SYSTEM

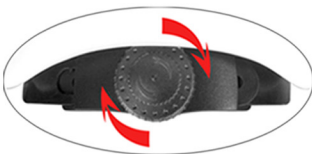



CARBONE

SKIDS CONTROL

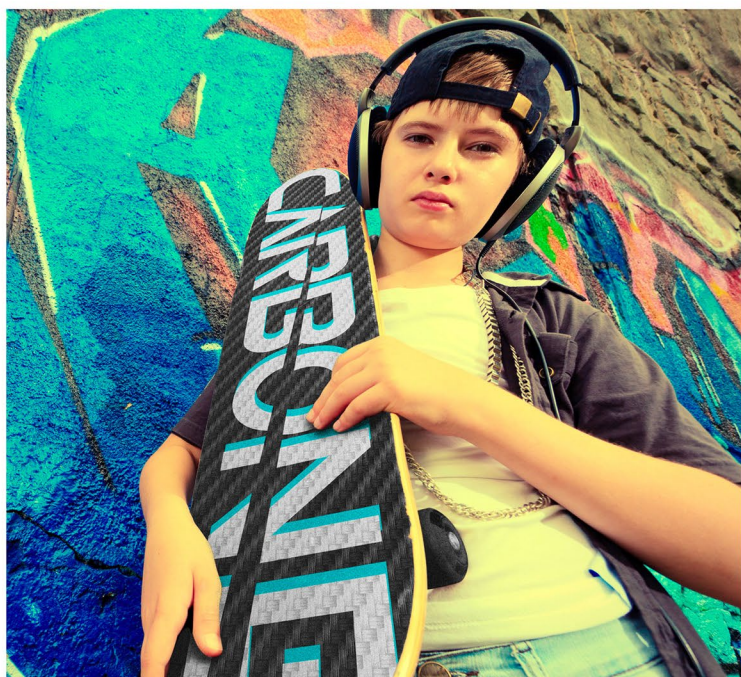

FACINGS EXAMPLE



OXYGEN RANGE



INNOVATION
QUALITY
STYLE
DESIGN



200 MM

- Foldable scooter 200mm
- PU Wheels
- BEARING ABEC-9
- Front shock-absorbing
- Adjustable height three sizes
- Kickstand
- 95% aluminium
- Large anti slip Aluminium deck : 560mm x 135mm
- Rear Brake
- TPR comfortable grips
- Max Weight 100Kg

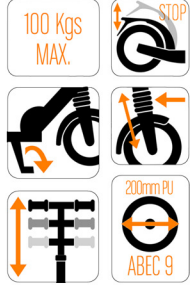

OX794200





200 MM

- Foldable scooter 200mm
- PU Wheels
- BEARING ABEC-9
- Front shock-absorbing
- Adjustable height three sizes
- Kickstand
- 95% aluminium
- Large anti slip Aluminium deck : 560mm x 135mm
- Rear Brake
- TPR comfortable grips
- Max Weight 100Kg



OX794201



- ADJUSTABLE SEMI SOFT IN LINE SKATES
- SIZES 38 - 41
- EASY AND QUICK TO ADJUST WITH ITS A PUSH BUTTON
- PU WHEELS
- ABEC 7 BALL BEARINGS
- ALUMINIUM CHASSIS
- SAFETY CLOSING BUCKLES
- FEET SUPPORT AND COMFORT WITH TRIPLE TIGHTENING SYSTEM: BUCKLES, LACES & VELCRO STRAP
- ONE REAR BRAKE

OX794302



- ADJUSTABLE SEMI SOFT IN LINE SKATES
- SIZES 42 - 45
- EASY AND QUICK TO ADJUST WITH ITS A PUSH BUTTON
- PU WHEELS
- ABEC 7 BALL BEARINGS
- ALUMINIUM CHASSIS
- SAFETY CLOSING BUCKLES
- FEET SUPPORT AND COMFORT WITH TRIPLE TIGHTENING SYSTEM: BUCKLES, LACES & VELCRO STRAP
- ONE REAR BRAKE

OX794303





OX794310



- CRUISER 27,5" x 8" (70 x 20 cm)
- TRUCK 5" ALUMINIUM
- CHINESE MAPPLE 9 LAYERS
- PRINTED ANTI SLIP DECK
- PU WHEELS 60 X45 MM
- ABEC 7 BEARING
- TWO SIDES PRINTING

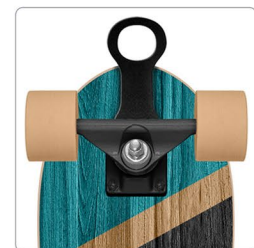



OXYGEN

SKIDS CONTROL







PA450250

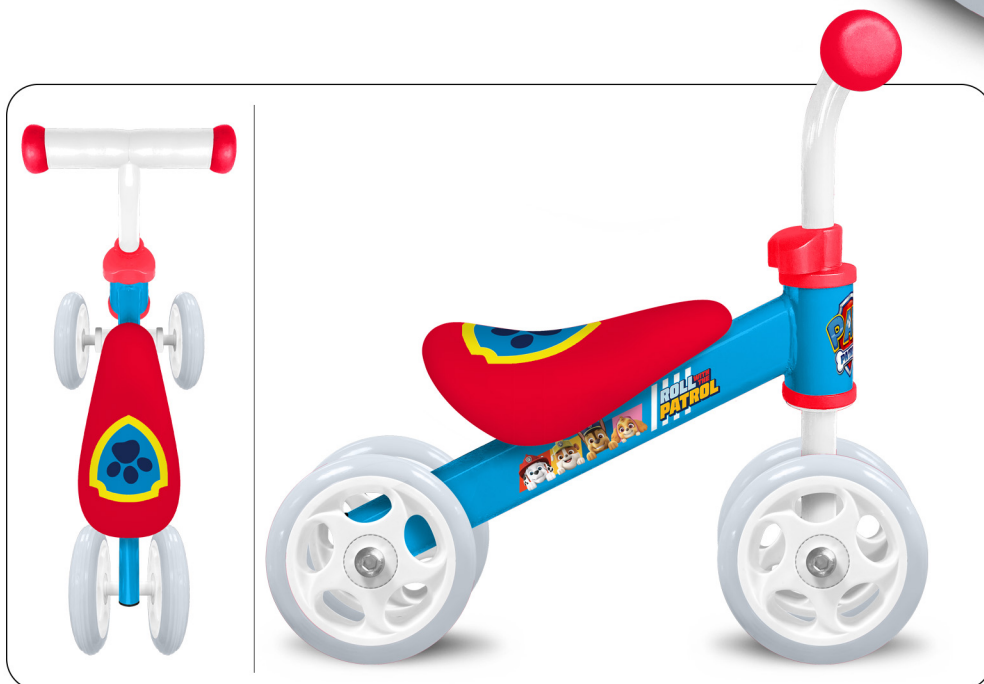

- 4 wheels Baby walker ride on.
- Steel Frame, close to the bottom for safety and easy to climb on it.
- 4 big PVC wheels for a better stability.
- Large Foam saddle for comfort and safety.
- Adjustable saddle and handlebars.
- Anti-pinch EVA grips.
- Limitation of the steering angle.
- Stimulates and helps to learn the balance.
- Easy and quick to assemble



PA450050



MAX. WEIGHT : 20 KG



ANTI SLIP DECK



VIEW DECK

PA450045

DECK VIEW

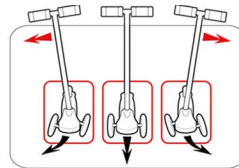

PA450042

VIEW DECK



ADJUSTABLE HEIGHT



REAR BRAKE



SECURE FOLDING MECHANISM



ANTI SLIP DECK

120 mm
INJECTION WHEELS
ABEC 5 BEARINGS
MAX. WEIGHT: 50 Kg





PA450006



- STEEL FRAME
- EVA TYRES
- ABEC 5 BEARINGS
- SADDLE & HANDLE BAR AJUSTABLE
- FOAM SADDLE
- STEERING STOP
- FULL COLOR BOX PACKAGING

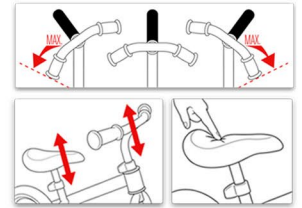

PA450035
(SIZES: 23-27)

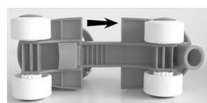

QUICK & EASY ADJUSTMENT
EN71 / 20 KG MAX.



QUICK & EASY ADJUSTMENT
EN14120 + A1 : 2007 / RANGE A LEVEL 1 - 25 KG MAX.





PA450301:
(27-30)

4 SIZES ADJUSTMENT

SIZE	BOY	GIRL
27/30	3-7 YEARS	4-7 YEARS
30/33	5-9 YEARS	6-10 YEARS
34/37	8-10 YEARS	8-12 YEARS

BEARING 608Z
MAX. WEIGHT: 20 Kg

TRISKATES TO IN LINES



SIZE ADJUSTMENT



PA450310

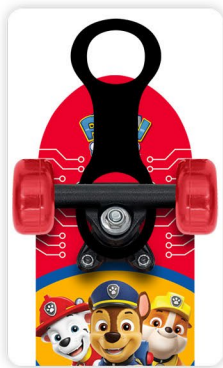

SKATEBOARD 17" x 5"
WITH HANGER
PVC WHEELS
2 SIDES DECORATIONS

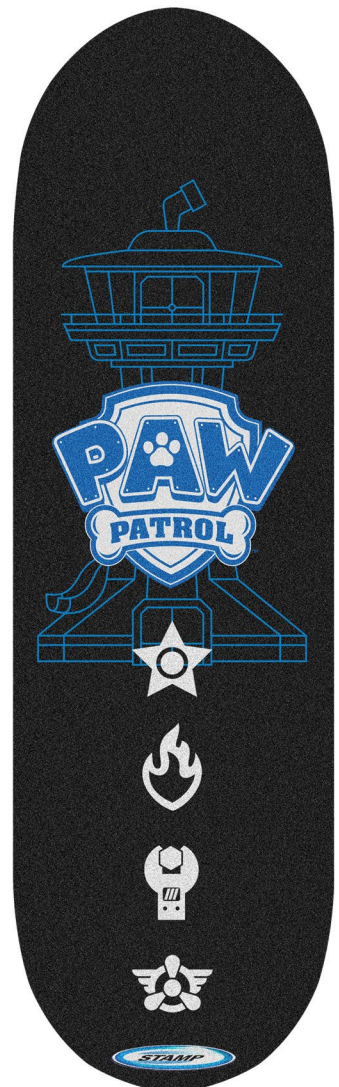



PA450100S

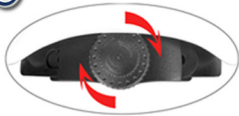

HEAD RING ADJUSTMENT SYSTEM
Approximate sizes: 50-56 cm
FOAM PADS
CE - EN1078 + A1 : 2012



PA450061



PA450094



PA450084



PA450053



PA450040





PA450507

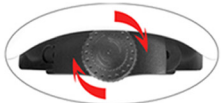

HEAD RING ADJUSTMENT SYSTEM
 Approximate sizes: 50-56 cm
 FOAM PADS
 CE - EN1078 + A1: 2012



QUICK & EASY ADJUSTMENT
 EN14120 + A1: 2007 / RANGE A LEVEL 1
 25 KG MAX.



PA450508

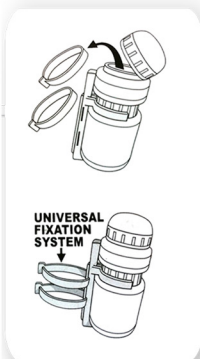

Barbie[®]



Barbie™

CB200050



MAX. WEIGHT : 20 KG

CB200045

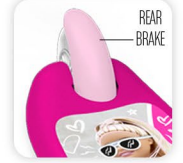
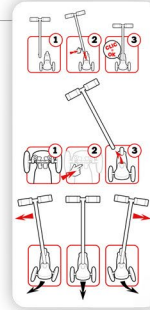

ABEC 5 BEARING
MAX. WEIGHT : 20 KG

ADJUSTABLE HEIGHT



ANTI SLIP DECK



SECURE FOLDING MECHANISM



REAR BRAKE



120 mm INJECTION WHEELS - ABEC 5 BEARINGS - MAX. WEIGHT: 50 KG

CB200042



Barbie

CB200301
(SIZES: 27-30)



PUSH BUTTON FOR A QUICK AND EASY ADJUSTMENT
BEARING 608Z
MAX. WEIGHT: 20 KG

4 SIZES ADJUSTMENT

SIZE	BOY	GIRL
27/30	3-7 YEARS	4-7 YEARS
30/33	5-9 YEARS	6-10 YEARS
34/37	8-10 YEARS	8-12 YEARS

BEARING 608Z
MAX. WEIGHT: 60 Kg

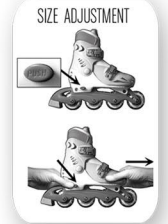

Push button for a quick and easy adjustment



CB200302
(SIZES: 30-33)



STEEL FRAME
EVA TYRES
ABEC 5 BEARINGS
SADDLE & HANDLE BAR ADJUSTABLE
FOAM SADDLE
STEERING STOP

CB200006



Barbie™

CB200100S

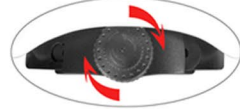

HEAD RING ADJUSTMENT SYSTEM
APPROXIMATE SIZES: 50-56 CM
FOAM PADS
CE EN 1078

CB200507

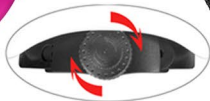

HEAD RING ADJUSTMENT SYSTEM
APPROXIMATE SIZES: 50-56 CM
FOAM PADS
CE EN 1078



QUICK & EASY ADJUSTMENT
EN 14120:2003 + A1:2007
TYPE 2 - LEVEL 1 - RANGE A
MAX. WEIGHT: 25 KG

CB200508







120 mm INJECTION WHEELS - ABECE 5 BEARINGS - MAX. WEIGHT: 50 KG



HW500042





HW500310



WITH HANGER
28 X 8" - PVC WHEELS - TWO SIDES DECORATIONS

HW500102



TECHNICAL DETAILS:
- BLACK EPS
- FOAM PAD INCLUDED
- ABS SHELL
- 53-57 CM

MARVEL
AVENGERS

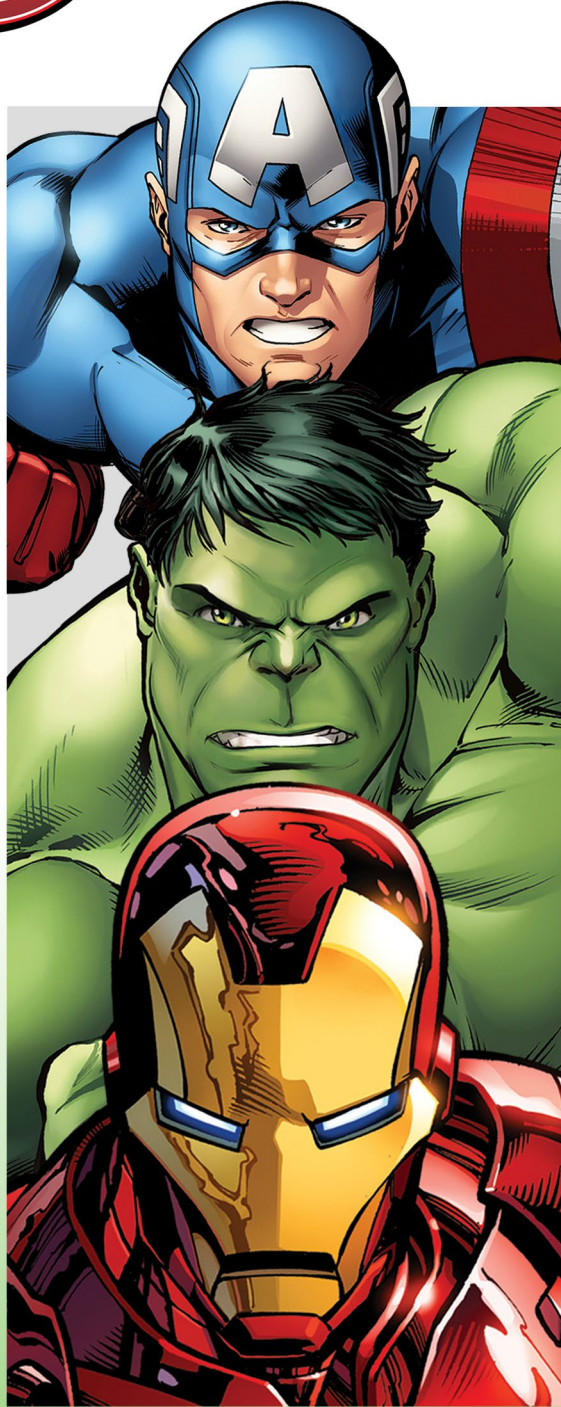



AV299042



120 mm
INJECTION WHEELS
ABEC 5 BEARINGS
MAX. WEIGHT: 50 Kg



MARVEL
AVENGERS



AV299310
(28 x 8)

WITH HANGER



AV299102
(53-57 cm)



- TECHNICAL DETAILS:
- BLACK EPS
 - FOAM PAD INCLUDED
 - ABS SHELL
 - 53-57 CM



AV299103S

Approximate sizes: 50-56 cm
FOAM PADS
CE - EN1078 + A1 : 2012



TOP VIEW



AV299507



Approximate sizes: 50-56 cm
FOAM PADS
CE - EN1078 + A1 : 2012

QUICK & EASY ADJUSTMENT
EN14120 + A1 : 2007 / RANGE A LEVEL 1
25 KG MAX.



Packaging which allows consumer to try the helmet. Elbow and Knee pads are protected under a blister.

MARVEL
SPIDEY
and his **AMAZING FRIENDS**



SP330050



ANTI SLIP DECK



ADJUSTABLE HEIGHT

MAX. WEIGHT : 20 KG



SP330045

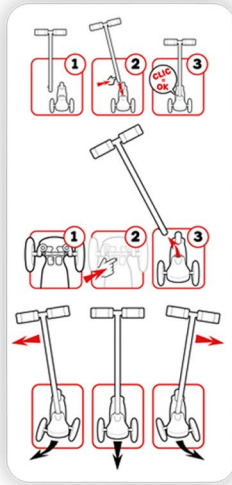

ANTI SLIP DECK



REAR BRAKE

ABEC 5 BEARING
MAX. WEIGHT : 20 KG



SP330006



STEEL FRAME
EVA TYRES
ABC: 5 BEARINGS
SADDLE & HANDLE BAR ADJUSTABLE
FOAM SADDLE
STEERING STOP



SP330035
(SIZES: 23-27)



QUICK & EASY ADJUSTMENT
EN71 / 20 KG MAX.



QUICK & EASY ADJUSTMENT
EN14120 + A1 : 2007 / RANGE A LEVEL 1 - 25 KG MAX.



SP330100S

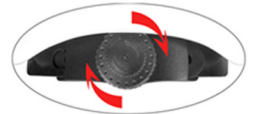

HEAD RING ADJUSTMENT SYSTEM
Approximate sizes: 50-56 cm
FOAM PADS
CE - EN1078 + A1 : 2012



SP330507

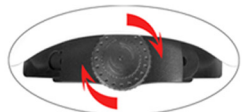

HEAD RING ADJUSTMENT SYSTEM
Approximate sizes: 50-56 cm
FOAM PADS
CE - EN1078 + A1 : 2012

PACKAGING WHICH ALLOWS
CONSUMER TO TRY THE HELMET
ELBOW & KNEE PADS ARE
PROTECTED UNDER A BLISTER



QUICK & EASY ADJUSTMENT
EN14120 + A1 : 2007 / RANGE A LEVEL 1
25 KG MAX.

SP330310

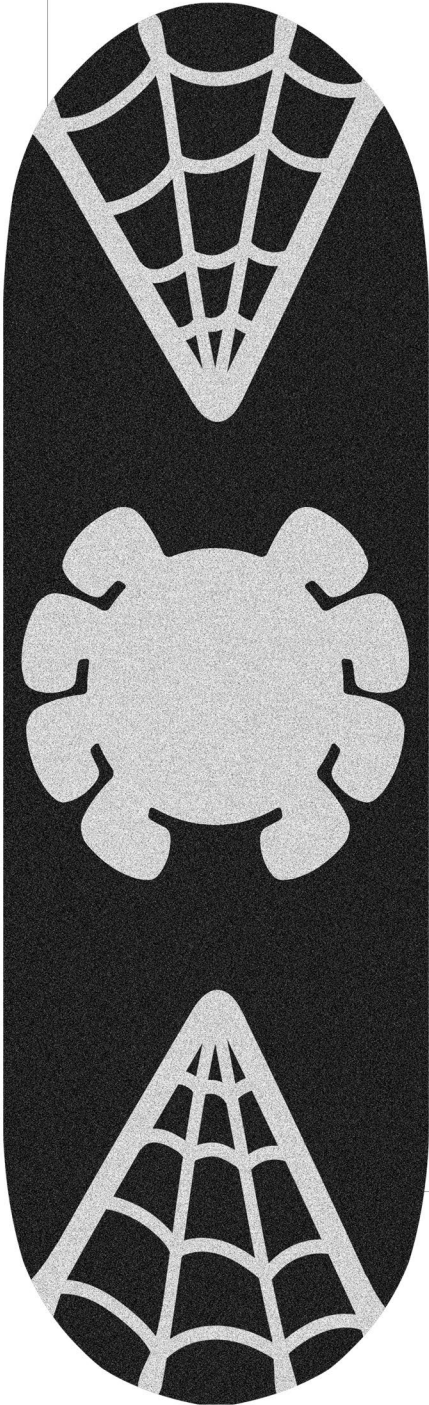

WITH HANGER

17 X 5"

PVC WHEELS

TWO SIDES DECORATIONS



MARVEL
SPIDER-MAN





SM250050



MAX. WEIGHT: 20 Kg



SM250045

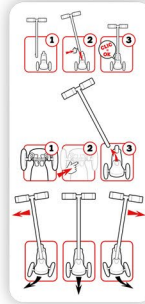

ABEC 5 BEARING
MAX. WEIGHT: 20 KG



SM250042

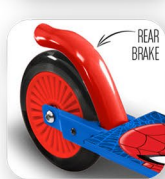

120 mm
INJECTION WHEELS
ABEC 5 BEARINGS
MAX. WEIGHT: 50 Kg





SM250035 : (Sizes 23-27)



Combo Roller Skating Set

QUICK & EASY ADJUSTMENT
EN1420 + A1 : 2007 / RANGE A LEVEL 1
25 KG MAX.

QUICK AND EASY ADJUSTMENT

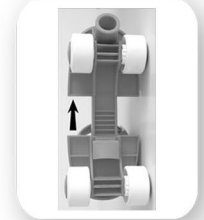

EN71 / 20 KG MAX.

BEARING 608Z
MAX. WEIGHT: 20 Kg

TRISKATES TO IN LINES



SIZE ADJUSTMENT



Push button For a quick and easy adjustment



SM250301 : (Sizes: 27-30)



4 SIZES ADJUSTMENT

SIZE	BOY YEARS	GIRL YEARS
27/30	3-7 YEARS	4-7 YEARS
30/33	5-9 YEARS	6-10 YEARS
34/37	8-10 YEARS	8-12 YEARS

BEARING 608Z
MAX. WEIGHT: 60 Kg

SIZE ADJUSTMENT

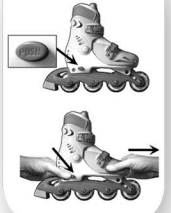

Push button For a quick and easy adjustment



SM250302 : (Sizes: 30-33)





SM250310
(28" X 8")

PVC WHEELS
TWO SIDE DECORATIONS

WITH HANGER



SM250102
(53-57 cm)



FRONT VIEW

TECHNICAL DETAILS:
- BLACK EPS
- FOAM PAD INCLUDED
- ABS SHELL
- 53-57 CM



TECHNICAL DETAILS:

- 1- Steel Frame
- 2- EVA Tyres
- 3- ABEC 5 Bearings
- 4- Saddle & Handle bar adjustable
- 5- Foam Saddle
- 6- Steering stop



SM250006





SM250103S



Approximate sizes: 53-56 cm
FOAM PADS
CE - EN1078 + A1 : 2012

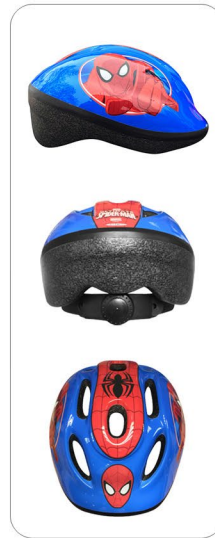

SM250061



SM250094



QUICK & EASY ADJUSTMENT
EN14120 + A1 : 2007 / RANGE A LEVEL 1
25 KG MAX.



SM250084



SM250040



SM250057

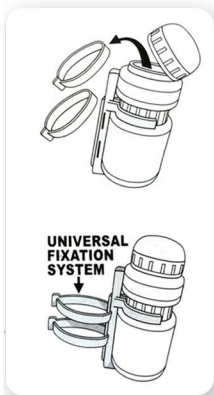

SM250053





**SAFETY COMBO SET:
SM250507**

Packaging which allows consumer to try the helmet. Elbow and Knee pads are protected under a blister.



Approximate sizes: 53-56 cm
FOAM PADS
CE - EN1078 + A1 : 2012



QUICK & EASY ADJUSTMENT
EN14120 + A1 : 2007 / RANGE A LEVEL 1
25 KG MAX.

SM250508



FROM THE MOVIE

Disney

WISH



2024



FROM THE MOVIE

Disney
WISH

WI467050



WI467045

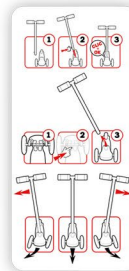

ABEC 5 BEARING
MAX. WEIGHT: 20 KG



WI467042

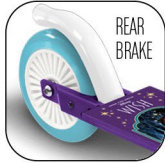

120 mm
INJECTION WHEELS
ABEC 5 BEARINGS
MAX. WEIGHT: 50 Kg

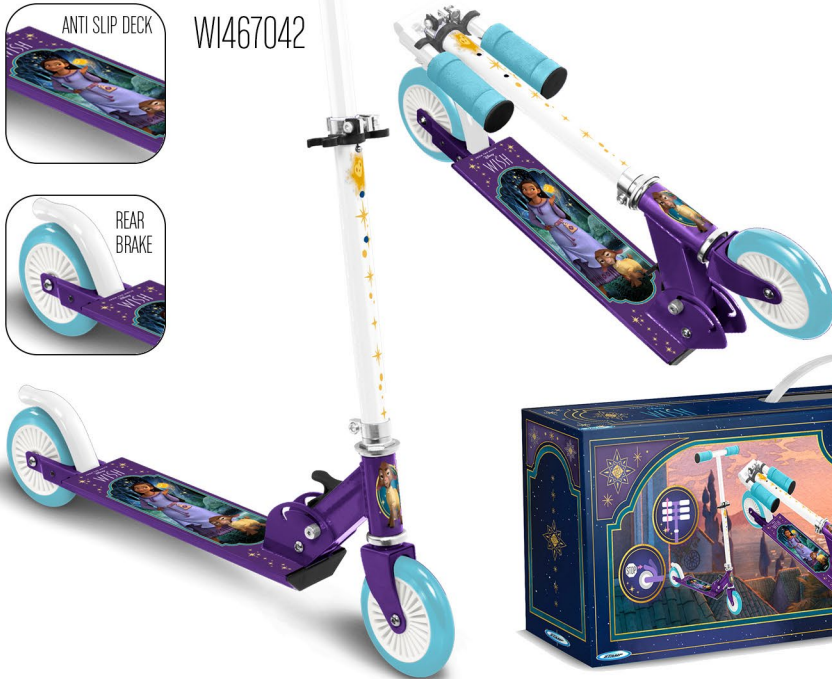

FROM THE MOVIE

Disney WISH

BEARING 608Z
MAX. WEIGHT: 20 Kg

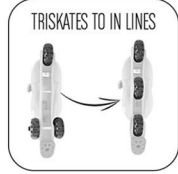

4 SIZES ADJUSTMENT

SIZE	BOY	GIRL
27/30	3-7 YEARS	4-7 YEARS
30/33	5-9 YEARS	6-10 YEARS
34/37	8-10 YEARS	8-12 YEARS



WI467301 :
(Sizes: 27-30)



WI467100S

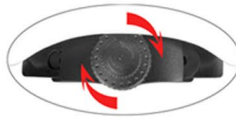

HEAD RING ADJUSTMENT SYSTEM
Approximate sizes: 50-56 cm
FOAM PADS
CE - EN1078 + A1 : 2012



WI467507



QUICK & EASY ADJUSTMENT
EN14120 + A1 : 2007 / RANGE A LEVEL 1
25 KG MAX.

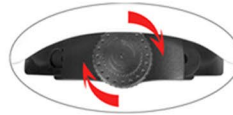

HEAD RING ADJUSTMENT SYSTEM
Approximate sizes: 50-56 cm
FOAM PADS
CE - EN1078 + A1 : 2012

PACKAGING WHICH ALLOWS
CONSUMER TO TRY THE HELMET
ELBOW & KNEE PADS ARE
PROTECTED UNDER A BLISTER



Stitch



Stitch

ST626050



- 3 WHEELS SCOOTER
- LARGE & ANTI SLIP DECK
- ADJUSTABLE HEIGHT
- LARGE & EASY GRIP HANDLES
- NICE FRONT PLATE



ST626042



- 120MM INJECTION WHEELS
- ABEC 5 BEARINGS
- MAX. WEIGHT: 50 KGS
- HEIGHT ADJUSTABLE HANDLES
- SECURE HOLDING MECHANISM
- ANTI SLIP DECK
- REAR BRAKE



Stitch

ST626100S



ST626507



Stitch

ST626700

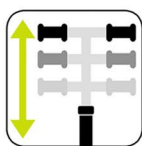

TECHNICAL DETAILS:

- PU WHEELS
- ABEC 5 BEARINGS
- ALUMINIUM & STEEL FRAMES & TUBES
- LARGE DECK SIZE
- MAX. WEIGHT: 100 KGS
- WIDE ANTI SLIP TRAY
- HEIGHT ADJUSTABLE HANDLES



Stitch

ST626102



TECHNICAL DETAILS:

- BLACK EPS
- FOAM PAD INCLUDED
- ABS SHELL
- 53-57 CM



ST626310



- CRUISER 27,5" x 8" (70 x 20 cm)
- HIGH RESISTANCE PP TRUCK
- CHINESE MAPPLE 9 LAYERS
- PRINTED ANTI SLIP DECK
- PU WHEELS 60 X 45 MM
- ABEC 5 BEARINGS
- TWO SIDES PRINTING



MINNIE





Minnie

it's ME

J862035 (Sizes: 23-27)



QUICK & EASY ADJUSTMENT
EN14120 + A1 : 2007 / RANGE A LEVEL 1
25 KG MAX.

QUICK AND EASY ADJUSTMENT

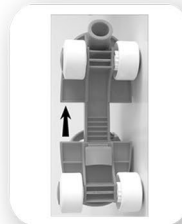

EN71 / 20 KG MAX.

J100930 (Sizes: 27-30)



PUSH BUTTON FOR A
QUICK AND EASY ADJUSTMENT



MAX. WEIGHT: 20 Kg

SIZE ADJUSTMENT



4 SIZES ADJUSTMENT

SIZE	BOY YEARS	GIRL YEARS
27/30	3-7	4-7
30/33	5-9	6-10
34/37	8-10	8-12

TRISKATES TO IN LINES



J862028 : (SIZE 28)

J862029 : (SIZE 29)

J862030 : (SIZE 30)



C862006



TECHNICAL DETAILS:
1- Steel Frame
2- EVA tyres
3- ABEC 5 Bearings
4- Saddle & Handle bar
adjustable
5- Foam Saddle
6- Steering stop



Minnie

it's ME

C862100XS: (approximate 48-52 cm)
 C862100S: (approximate 53-56 cm)



FOAM PADS
 CE - EN1078 + A1 : 2012
 HEAD RING ADJUSTMENT SYSTEM

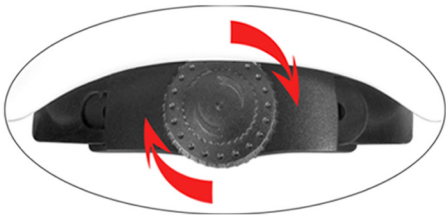

C862061



C862094



QUICK & EASY ADJUSTMENT
 EN14120 + A1 : 2007 / RANGE A LEVEL 1
 25 KG MAX.

C862053



C862057

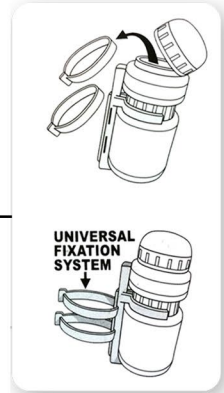

C862084



C862040

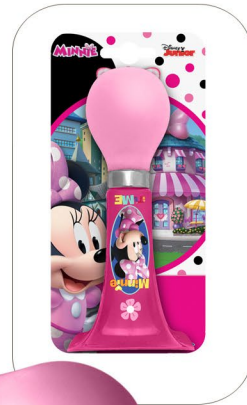

C862500



K862507



SAFETY COMBO SET

Packaging which allows consumer to try the helmet. Elbow and Knee pads are protected under a blister.

Head ring adjustment system

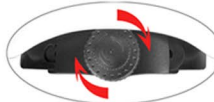

Approximate sizes: 53-56 cm

FOAM PADS

CE - EN1078 + A1 : 2012

QUICK & EASY ADJUSTMENT
EN14120 + A1 : 2007 / RANGE A LEVEL 1
25 KG MAX.



K862508



TOY COMBO SET



Play time Mickey



Play time Mickey

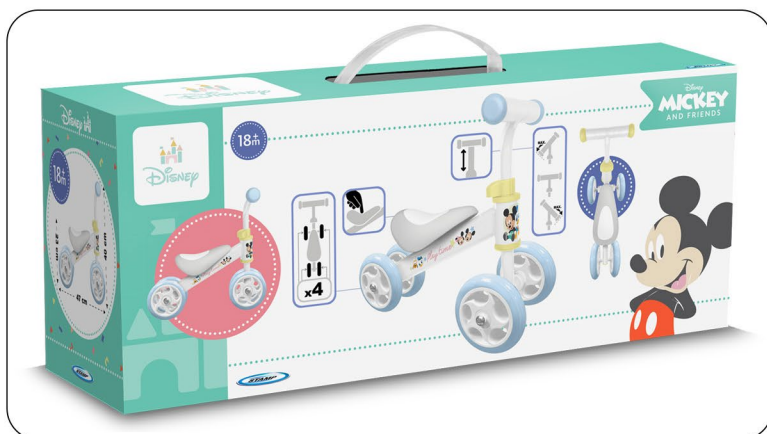

BB183250



- Adjustable handlebar.
- Anti-pinch EVA grips.
- Limitation of the steering angle.
- Stimulates and helps to learn the balance.
- Easy and quick to assemble
- 4 wheels Baby walker ride on.
- Steel Frame, close to the bottom for safety and easy to climb on it.
- 4 big PVC wheels for a better stability.
- Large foam saddle for comfort and safety.

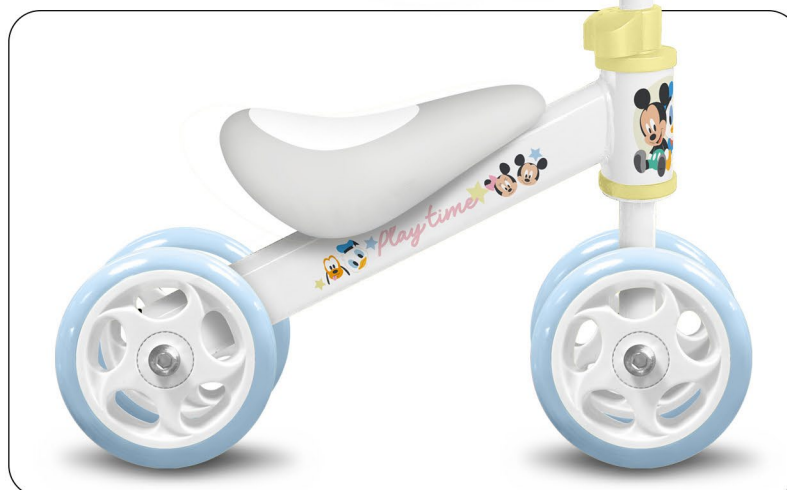

Disney **MICKEY**
AND THE
ROADSTER
RACERS



MICKEY MOUSE CLUBHOUSE



J100046

MAX. WEIGHT: 20 Kg



K865507

Packaging which allows consumer to try the helmet Elbow and Knee pads are protected under a blister

Approximate sizes: 53-56 cm
FOAM PADS
CE - EN1078 + A1 : 2012



Head ring adjustment system



QUICK & EASY ADJUSTMENT
EN14120 + A1 : 2007 / RANGE A LEVEL 1
25 KG MAX.



MR875045

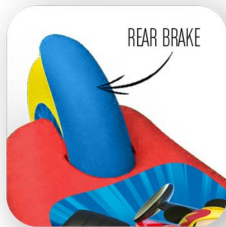

ABEC 5 BEARING
MAX. WEIGHT: 20 KG

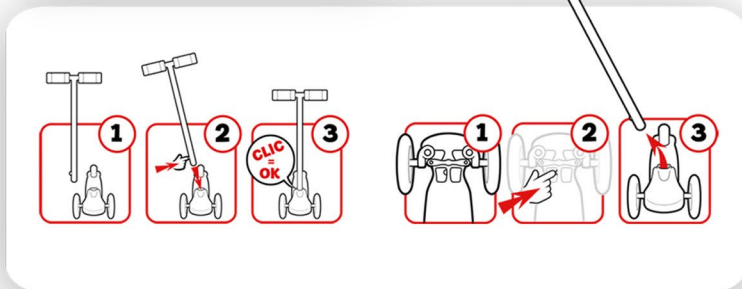
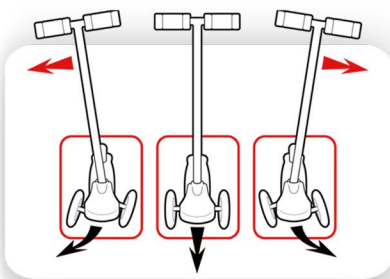

MR875002



ADJUSTABLE SEAT
STEEL FRAME
HAND BRAKE
PP WHEELS: 190mm DIAMETER





C893050



MAX. WEIGHT: 20 Kg



C893045

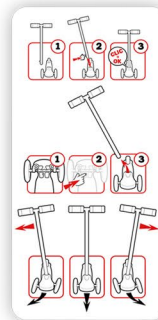

ABEC 5 BEARING
MAX. WEIGHT: 20 KG



C893042



120 mm
INJECTION WHEELS
ABEC 5 BEARINGS
MAX. WEIGHT: 50 Kg





J893002



ADJUSTABLE SEAT
STEEL FRAME
HAND BRAKE
PP WHEELS: 190mm DIAMETER



C893100XS (approximate 48 - 52 CM)
 C893100S (approximate 53 - 56 CM)



FOAM PADS
 CE - EN1078 + A1 : 2012



C893507



Approximate sizes: 53-56 cm
 FOAM PADS
 CE - EN1078 + A1 : 2012

QUICK & EASY ADJUSTMENT
 20 + A1 : 2007 / RANGE A LEVEL 1
 25 KG MAX.



K892508

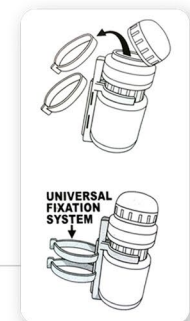

From the Movie

Disney
FROZEN II



From the Movie
Disney FROZEN II

MAX. WEIGHT: 20KG

RN244050

ADJUSTABLE HEIGHT

ANTI SLIP DECK

RN244045

ABEC 5 BEARING
 MAX. WEIGHT: 20 KG

REAR BREAK

ANTI SLIP DECK

RN244042

REAR BREAK

ADJUSTABLE HEIGHT

ANTI SLIP DECK

SECUR FOLDING MECHANISM

120MM INJECTION WHEELS
 ABEC 5 BEARINGS
 MAX. WEIGHT: 50 KG

From the Movie
Disney FROZEN II

RN244301: (sizes 27-30)



BEARING 608Z
 MAX. WEIGHT: 20 Kg

Push button for a quick and easy adjustment



SIZE	BOY	GIRL
27/30	3-7 YEARS	4-7 YEARS
30/33	5-9 YEARS	6-10 YEARS
34/37	8-10 YEARS	8-12 YEARS

RN244302: (sizes 30-33)



BEARING 608Z
 MAX. WEIGHT: 60 Kg



Push button for a quick and easy adjustment

RN244035: (sizes 23-27)



EN71 / 20 KG MAX.
 QUICK & EASY ADJUSTMENT

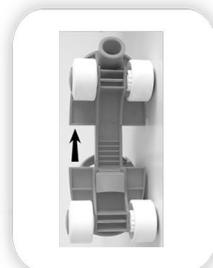

QUICK & EASY ADJUSTMENT
 EN14120 + A1: 2007 / RANGE A LEVEL 1
 25 KG MAX.

From the Movie
Disney FROZEN II

RN244006



- STEEL FRAME
- EVA TYRES
- ABEC 5 BEARINGS
- SADDLE & HANDLE BAR
- ADJUSTABLE
- FOAM SADDLE
- STEERING STOP



RN244061



- RN244100XS
(approximate 48-52 CM)
- RN244100S
(approximate 53-56 CM)

HEAD RING ADJUSTMENT SYSTEM

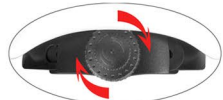

FOAM PADS
 CE - EN1078 + A1 : 2012



RN244094



QUICK & EASY ADJUSTMENT
 — EN14120 + A1 : 2007 / RANGE A LEVEL 1
 25 KG MAX.

RN244053



RN244057

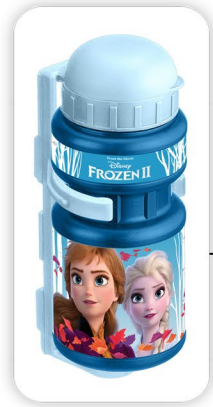

UNIVERSAL
 FIXATION
 SYSTEM



RN244040



RN244084



RN244500



RN244507

PACKAGING WHICH ALLOWS CONSUMER TO TRY THE HELMET
 ELBOW & KNEE PADS ARE PROTECTED UNDER A BLISTER



Approximate sizes: 53-56 cm
 FOAM PADS
 CE - EN1078 + A1 : 2012



QUICK & EASY ADJUSTMENT
 EN14120 + A1 : 2007 / RANGE A LEVEL 1
 25 KG MAX.



RN244508

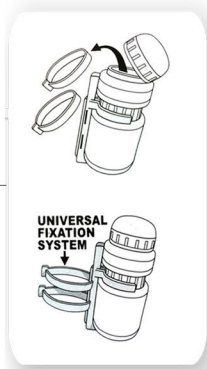



Disney
PRINCESS

The logo features the word "Disney" in a white, cursive font above the word "PRINCESS" in a white, serif font. Both are set against a magenta, crown-shaped background with a white outline. A large, clear diamond is positioned at the top center of the crown, and several smaller diamonds are arranged in a row at the bottom.

Disney Princess

J100078



MAX. WEIGHT: 20 Kg



C887045

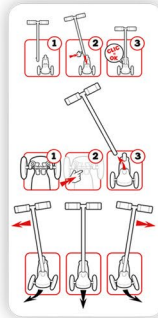

ABEC 5 BEARING
MAX. WEIGHT: 20 KG



J100088



120 mm
INJECTION WHEELS
ABEC 5 BEARINGS
MAX. WEIGHT: 50 Kg





J100038
(Sizes: 23-27)



QUICK & EASY ADJUSTMENT
EN14120 + A1 : 2007 / RANGE A LEVEL 1
25 KG MAX.

QUICK AND EASY ADJUSTMENT

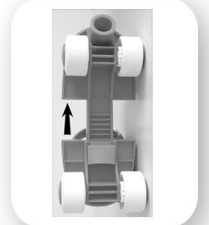

EN71 / 20 KG MAX.

J100830
(Sizes: 27-30)



4 SIZES ADJUSTMENT

SIZE	BOY	GIRL
27/30	3-7 YEARS	4-7 YEARS
30/33	5-9 YEARS	6-10 YEARS
34/37	8-10 YEARS	8-12 YEARS

PUSH BUTTON FOR A QUICK AND EASY ADJUSTMENT



MAX. WEIGHT: 20 Kg



C887022



TECHNICAL DETAILS:

- 1- Steel Frame
- 2- EVA tyres
- 3- ABEC 5 Bearings
- 4- Saddle & Handle bar ajustable
- 5- Foam Saddle
- 6- Steering stop



C887100S



Approximate sizes: 53-56 cm
FOAM PADS
CE - EN1078 + A1 : 2012



K887507



Approximate sizes: 53-56 cm
FOAM PADS
CE - EN1078 + A1 : 2012

QUICK & EASY ADJUSTMENT
EN14120 + A1 : 2007 / RANGE A LEVEL 1
25 KG MAX.



K887508

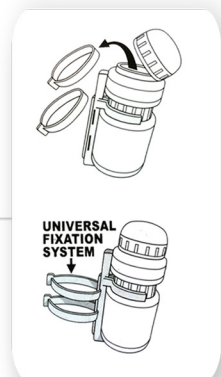

UNIVERSAL
FIXATION
SYSTEM

NOTES

NOTES



2024



7 Rue Denis PAPIN - 67400 ILLKIRCH GRAFFENSTADEN - FRANCE

Phone : +33 (0)3 88 67 22 23 Fax : +33 (0)3 88 66 71 78

E.mail : stamp@stamp-fr.com

SITE WEB: STAMP-FRANCE.FR

SKIDS CONTROL®

© Disney

© Disney/Pixar

© MARVEL

© 2023 Mattel

©2023 & TM Spin Master Ltd.

VERSION 28 SEPTEMBRE 2023



La société STAMP se réserve le droit de modifier sans préavis les caractéristiques des articles présentés dans ce catalogue.

Photos non - contractuelles.

The compagny STAMP reserves the right to modify without prior notice the items' specifications presented in this catalogue.

Pictures not contractual.