

## ► BLDC Actuator

**5846**

- Continuous Torque..... 3Nm
- Peak Torque..... 8Nm
- Weight ..... 1kg
- Communication..... CAN

Compactness, high torque and speed are the main features for this BLDC actuator. It is suitable for heavy duty harsh environments: trucks, agriculture & construction vehicles. It exhibits a great flexibility in electrical and mechanical interfaces, i.e. by integration of an absolute position sensor.

### ► Features & benefits

- Brushless DC motor with integrated CAN bus control electronics
- Torque output up to >8Nm peak
- Supply voltage range between 9V and 32V  
Lightweight, only 1kg
- Typical response time 125 ms
- Waterproof IP6K9K
- Operating temperature from -40°C to 140°C
- Integrated coolant canal
- Integrated connector or wire harness
- Failsafe position customizable
- Absolute position sensor optionally available
- Outstanding compactness allowing easy integration
- Suitable for most valve sizes thanks to its wide torque range
- High reliability and service life in commercial diesel harsh conditions
- High vibration and temperature resistance
- Accurate positioning for finer flow control

### ► Technical data

Operating Voltage	9-32	V
Resolution	0.24	°
Span	100	°
Speed	100	RPM

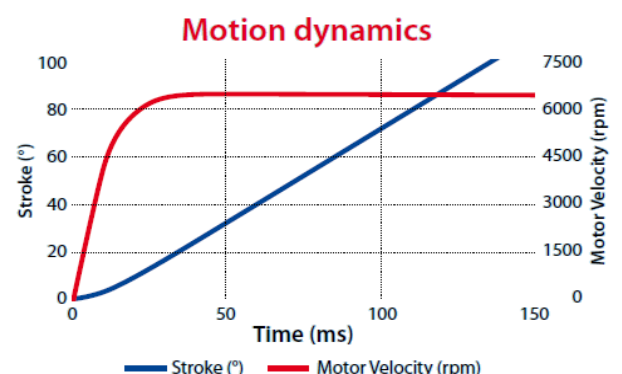

## ► Dimensions

Drawing not to scale. All dimensions in mm.

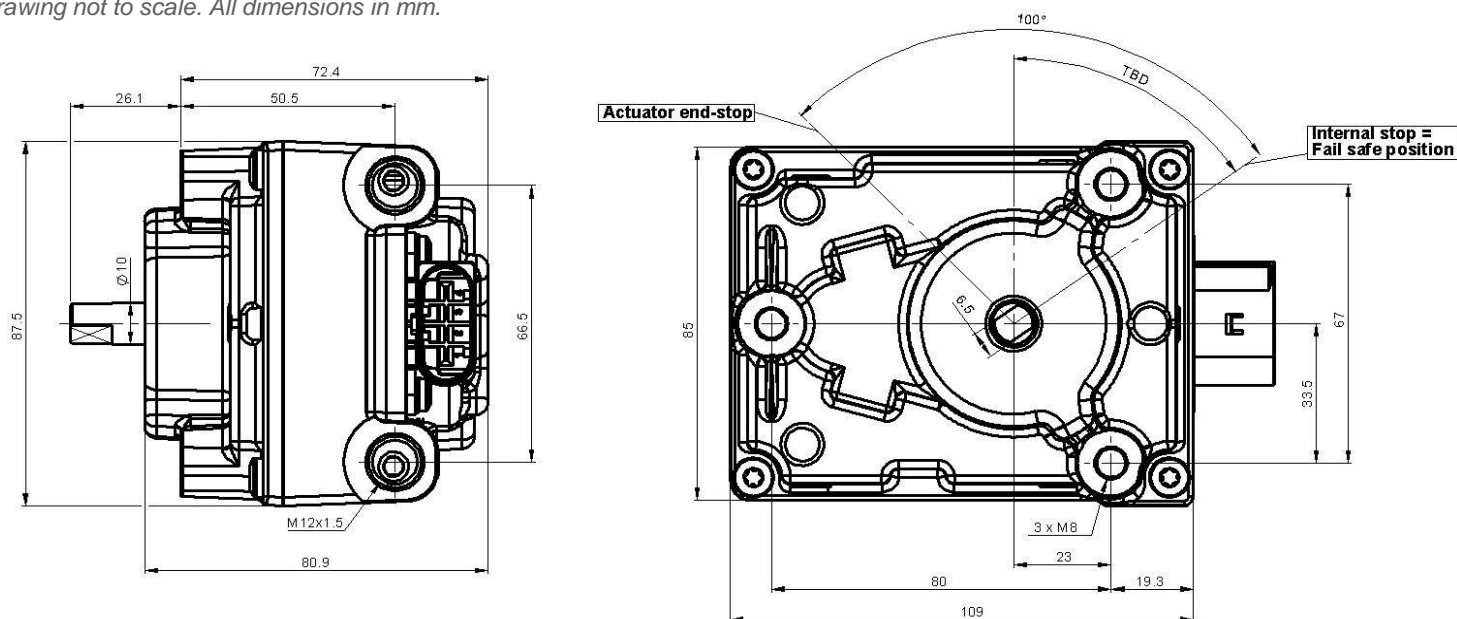

## ► Electrical and Mechanical Interface

Integrated Connector	4 Pins: Kostal SLK2.8
Wire Harness	4 to 8 Pins, Tyco, Deutsch, Kostal...
Pinout (for 4 Pins)	1= Vbat, 2=GND, 3=CAN_L, 4=CAN_H
Communication	CAN
Over and under voltage protection	Integrated
Maximum current	7A
Failsafe	Clockwise, counter clockwise and intermediate stroke positions
Output shaft	2 flats, knurls and M8...

## ► Operating conditions

Operating Temp. Range	-40°C / +150°C (with water-cooling)
Vibration Level	Up to 20gRMS – Bandwidth 20-2000Hz
Protection Class	IP 6K9K
ROHS (Lead Free)	Compliant
IMDS	Compliant

Special requirements upon customer specifications. Right to change reserved.

<2.0>

### SONCEBOZ SA

2605 Sonceboz – Switzerland

Tel. +41(0) 32 488 11 11

Fax +41(0) 32 488 11 00

info@sonceboz.com - www.sonceboz.com

